



ROD END SUPPLY

1-800-284-2902

www.rodendsupply.com

info@rodendsupply.com

copyright 2013

WARNING

RWD, Inc. d/b/a Rod End Supply sells only the finest quality rod ends and other components available in each style and category. Even when dimensionally similar, not all components are suitable for certain applications. DO NOT INSTALL COMPONENTS IN APPLICATIONS WHICH WILL SUBJECT THEM TO DYNAMIC LOADS WHICH EXCEED THEIR SPECIFICATIONS. INSTALLING COMPONENTS WHERE THEY MAY BE SUBJECTED TO DYNAMIC LOADS WHICH EXCEED THEIR SPECIFICATIONS MAY LEAD TO ACCIDENTS RESULTING IN PROPERTY DAMAGE, SERIOUS INJURY OR DEATH. IF YOU ARE NOT QUALIFIED TO MAKE A DETERMINATION REGARDING THE SUITABILITY OF A COMPONENT, SEEK THE ADVICE OF A COMPETENT ENGINEER. If you cannot be certain that the component sold by RWD, Inc. d/b/a Rod End Supply, is suitable for your intended application, you may return it in new condition, and in the original packaging, for a complete refund. Because the end user makes the sole determination of suitability for its application, RWD, Inc. d/b/a Rod End Supply, makes no recommendation or warranty, express or implied, as to merchantability, suitability for any purpose or longevity or safety. All specifications are listed in our catalog to assist the end user with making this determination. BECAUSE THE RACING ENVIRONMENT OFTEN EXPOSES VEHICLES TO STRESSES WHICH ARE NOT FORESEEABLE AND WHICH CAN EXCEED THE ABILITY OF ANY COMPONENT TO SURVIVE, THE END USER ASSUMES ALL RISK OF PROPERTY DAMAGE, INJURY OR DEATH WHICH MIGHT RESULT EVEN IF COMPONENTS ARE INSTALLED IN COMPLIANCE WITH ALL SPECIFICATIONS.

Rod End Service - Suspension Applications

Rod ends installed within their specifications must be inspected regularly for wear. Remove rod end regularly, clean thoroughly and inspect for looseness of the ball in the body, and for any sign of cracking or galling.

IF ANY LINEAR MOTION IS DETECTED BETWEEN THE BALL AND BODY, REPLACE ROD END IMMEDIATELY AND DO NOT OPERATE VEHICLE UNTIL ALL WORN ROD ENDS ARE REPLACED.

Be sure to follow lubrication directions specific to the type of rod end in use. IMMEDIATELY INSPECT ALL ROD ENDS ANY TIME THE VEHICLE IS SUBJECTED TO CONTACT WITH BARRIERS OR OTHER VEHICLES AND IMMEDIATELY AFTER THE VEHICLE SUFFERS ANY SUSPENSION DAMAGE.

SPECIAL WARNING

When using rod ends in throttle or brake linkage applications; Regularly inspect all linkage to insure all hardware, including jam nuts are tight. If nylon insert type lock nuts are used, do not reuse, install a new nut every time system is disassembled. Inspect linkage through its full range of motion to insure there is no binding, sticking or flexing of the components and to be sure that the linkage does not interfere with any other part of the vehicle. BE CERTAIN THAT THROTTLE LINKAGE RETURNS TO IDLE WHEN RELEASED.

TABLE OF CONTENTS

ABOUT ROD END SUPPLY	1
EM/EF.....	2
BBEM/HBBEM.....	3
PM/PF	4
PMX/PFX	5
HPMX-T	6
LXM/LXF.....	7
XM/XF.....	8
AM/AF.....	9
ROD END STUD DATA	10
COM/HCOM - SPHERICAL BEARINGS - UNIBALL CUPS	11
COM-N/HCOM-N - HIN-T.....	12
WSSX-T.....	13
RADIUS RODS - SWAGED ALUMINUM/STEEL/STAINLESS STEEL.....	14
RADIUS RODS - NON-SWAGED ALUMINUM	15
CLEVIS/BALL JOINTS.....	16
HIGH MISALIGNMENT SPACERS/CONE SPACERS	17
WELD-IN BUNGS	18
OFF-ROAD.....	19
SPRINT CARS/MIDGETS - SUSPENSION/STEERING	20-22
LATE MODEL/MODIFIED PARTS	23
STREET & STRIP.....	24
FASTENERS	25
CUSTOM PRODUCTS/SPECIALS	26-27
ORDER FORM.....	28

Not All Parts Shown in Catalog are in Stock

Dear Customer,

At Rod End Supply we have the unique opportunity to be involved with all sorts of auto racing and performance related industries including farming equipment. Whether your running a go-cart, micro, mini-sprint, midget, modified, late model, sprint or a tractor, Rod End Supply has the assortment of rod ends, radius rods and speciality products that will help you lead the field in performing at your maximum potential. Since 1989, Rod End Supply has provided superior products priced competitively, with prompt and courteous service. Our promise is to continue to provide superior service with superior product that will keep you in the front of your field.

Remember... We don't just sell em, We race em!

Robert Douglas

Robert (Bob) Douglas
President



EM, EF

ECONOMY SERIES & STEERING ROD END

LUBRICATION RECOMMENDATIONS

To insure proper function, the rod ends listed below must be lubricated. To insure complete lubrication, before installation, rotate ball bore 90 to installed position, fill housing with high-quality grease. Restore ball bore to installed position, wipe off excess grease and install.

CAUTION

Lubricants may attract dirt and other abrasive contamination. Rod ends must be removed, thoroughly cleaned, inspected, and re-greased whenever contamination of any kind is present.

DO NOT OPERATE VEHICLE WITH WORN OR CONTAMINATED ROD ENDS

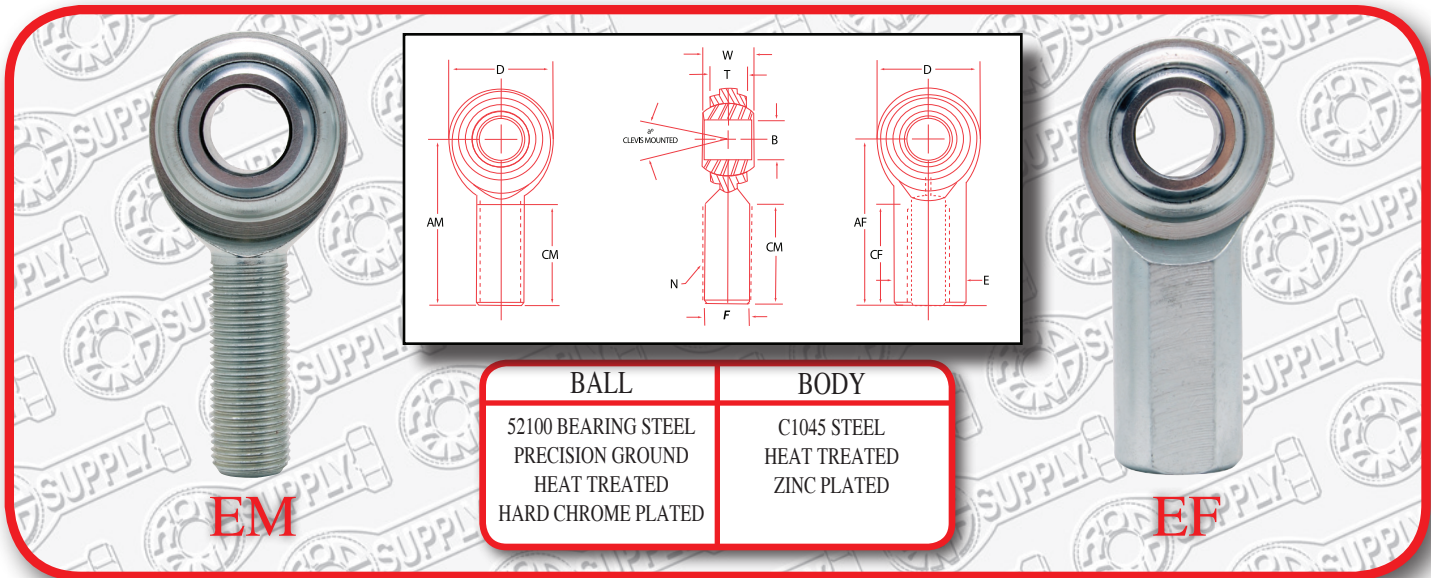

BALL	BODY
52100 BEARING STEEL PRECISION GROUND HEAT TREATED HARD CHROME PLATED	C1045 STEEL HEAT TREATED ZINC PLATED

RES PART NO.	BORE X THD. SIZE REF.	B DIA. +.0025 -0.005	D DIA. ± .010	W WIDTH ± .005	T WIDTH REF.	BALL DIA. REF.	AM LGTH. ± .015	AF LGTH. ± .015	N THD. UNF. 3A-2B	CM LGTH. +.062 -0.031	CF LGTH. +.062 -0.031	E DIA. ± .010	F FLAT ± .010	a° MIS. ANG. REF.	ULT. STATIC RADIAL LOAD (LBS.)	APPROX. WEIGHT (LBS.)
EM 3	3/16 x 10-32	.1900	.625	.312	.234	.437	1.250	-	10-32	.750	-	-	-	20	2,074	.03
EF 3	3/16 x 10-32	.1900	.625	.312	.234	.437	-	1.062	10-32	-	.500	.406	.312	20	2,079	.04
EM 4	1/4 x 1/4-28	.2500	.750	.375	.250	.500	1.562	-	1/4-28	1.000	-	-	-	27	3,820	.04
EF 4	1/4 x 1/4-28	.2500	.750	.375	.250	.500	-	1.312	1/4-28	-	.687	.469	.375	27	3,820	.05
EM 5	5/16 x 5/16-24	.3125	.875	.437	.312	.625	1.875	-	5/16-24	1.250	-	-	-	22	5,110	.07
EF 5	5/16 x 5/16-24	.3125	.875	.437	.312	.625	-	1.375	5/16-24	-	.687	.500	.437	22	5,110	.08
EM 6	3/8 x 3/8-24	.3750	1.000	.500	.359	.719	1.938	-	3/8-24	1.250	-	-	-	22	7,605	.11
EF 6	3/8 x 3/8-24	.3750	1.000	.500	.359	.719	-	1.625	3/8-24	-	.812	.687	.562	22	7,605	.13
EM 7	7/16 x 7/16-20	.4375	1.125	.562	.406	.812	2.125	-	7/16-20	1.375	-	-	-	21	9,122	.15
EF 7	7/16 x 7/16-20	.4375	1.125	.562	.406	.812	-	1.812	7/16-20	-	.937	.750	.625	21	9,122	.18
EM 8	1/2 x 1/2-20	.5000	1.312	.625	.453	.937	2.438	-	1/2-20	1.500	-	-	-	20	12,224	.24
EF 8	1/2 x 1/2-20	.5000	1.312	.625	.453	.937	-	2.125	1/2-20	-	1.062	.875	.750	20	12,224	.29
EM10	5/8 x 5/8-18	.6250	1.500	.750	.484	1.125	2.625	-	5/8-18	1.625	-	-	-	26	13,540	.36
EF 10	5/8 x 5/8-18	.6250	1.500	.750	.484	1.125	-	2.500	5/8-18	-	1.375	1.000	.875	26	13,540	.43
EM 12	3/4 x 3/4-16	.7500	1.750	.875	.593	1.312	2.785	-	3/4-16	1.750	-	-	-	24	18,810	.57
EF 12	3/4 x 3/4-16	.7500	1.750	.875	.593	1.312	-	2.875	3/4-16	-	1.562	1.125	1.000	24	18,810	.65

HEAVY DUTY SHANK

EM 3-4	3/16 x 1/4-28	.1900	.750	.312	.234	.437	1.562	-	1/4-28	1.000	-	-	-	20	4,824	.04
EM 4-5	1/4 x 5/16-24	.2500	.875	.375	.250	.500	1.875	-	5/16-24	1.250	-	-	-	27	6,534	.06
EM 5-6	5/16 x 3/8-24	.3125	1.000	.437	.312	.625	1.938	-	3/8-24	1.250	-	-	-	22	7,920	.10
EM 6-7	3/8 x 7/16-20	.3750	1.125	.500	.359	.719	2.125	-	7/16-20	1.375	-	-	-	22	9,486	.14
EM 6-8	3/8 x 1/2-20	.3750	1.125	.500	.359	.719	2.125	-	1/2-20	1.375	-	-	-	22	9,486	.17
EM 7-8	7/16 x 1/2-20	.4375	1.312	.562	.406	.812	2.438	-	1/2-20	1.500	-	-	-	21	12,816	.22
EM 10-8	1/2 x 5/8-18	.5000	1.500	.750	.500	1.125	2.625	-	5/8-18	1.625	-	-	-	26	13,540	.40
EM 8-12	1/2 x 3/4-16	.5000	1.312	.750	.500	1.125	2.625	-	3/4-16	1.625	-	-	-	24	18,810	.45
EM 12-10	5/8 x 3/4-16	.6250	1.312	.875	.625	1.312	2.875	-	3/4-16	1.750	-	-	-	24	18,810	.60

STEERING ROD ENDS

EM10Z-102	5/8 x 5/8	.6250	1.750	.875	.593	1.312	2.625	-	5/8-18	1.750	-	-	-	24	15,000	.48
EMR12-.757	.757 x 3/4	.7570	1.750	.875	.593	1.312	2.875	-	3/4-16	1.750	-	-	-	24	18,810	.57

DO NOT INSTALL ANY COMPONENT LISTED ABOVE BEFORE READING, UNDERSTANDING AND ACCEPTING THE WARNINGS PRINTED ON PAGE 1 OF OUR CATALOG.

NOTES:

- FOR LEFT HAND THREADS ADD "L" TO PREFIX. EXAMPLE: EML12
- FOR STUDS ADD "Y" TO SUFFIX. EXAMPLE: EM6Y
- FOR TEFLON LINER ADD "T" TO SUFFIX. EXAMPLE: EM12T

BBEM/HBBEM

HIGH STRENGTH ALLOY STEEL

2 PIECE





BBEM

BALL	BODY
52100 BEARING STEEL PRECISION GROUND HEAT TREATED HARD CHROME PLATED	4130 CHROMOLY STEEL HEAT TREATED BLACK OXIDE COATED



HBBEM

BALL	BODY
52100 BEARING STEEL PRECISION GROUND HEAT TREATED HARD CHROME PLATED HIGH MISALIGNMENT	4130 CHROMOLY STEEL HEAT TREATED BLACK OXIDE COATED

RES PART NO.	BORE X THD. SIZE REF.	B DIA. +.0025 -0.0005	D DIA. ± .010	W WIDTH ± .005	T WIDTH REF.	BALL DIA. REF.	AM LGTH. ± .015	N THD. UNF. 3A	CM LGTH. +.062 -0.031	a ° MIS. ANG. REF.	ULT. STATIC RADIAL LOAD (LBS.)	APPROX. WEIGHT (LBS.)
BBEM 5	5/16 x 5/16-24	.3125	.875	.437	.312	.625	1.875	5/16-24	1.250	22	7,100	.07
BBEM 6	3/8 x 3/8-24	.3750	1.000	.500	.359	.719	1.938	3/8-24	1.250	22	10,500	.11
BBEM 7	7/16 x 7/16-20	.4375	1.125	.562	.406	.812	2.125	7/16-20	1.375	21	12,650	.15
BBEM 8	1/2 x 1/2-20	.5000	1.312	.625	.453	.937	2.438	1/2-20	1.500	20	17,000	.24
BBEM 10	5/8 x 5/8-18	.6250	1.500	.750	.484	1.125	2.625	5/8-18	1.625	26	18,000	.36
BBEM 12	3/4 x 3/4-16	.7500	1.750	.875	.593	1.312	2.875	3/4-16	1.750	24	25,000	.57
HEAVY DUTY SHANK												
BBEM 8-10	1/2 x 5/8-18	.5000	1.500	.625	.453	1.125	2.625	5/8-18	1.625	26	13,540	.30
BBEM 10-8	1/2 x 5/8-18	.5000	1.500	.750	.453	1.125	2.625	5/8-18	1.625	26	18,810	.30
BBEM 10-12	5/8 x 3/4-16	.6250	1.750	.750	.484	1.312	2.875	3/4-16	1.750	24	18,810	.48

RES PART NO.	BORE X THD. SIZE REF.	B DIA. +.0025 -0.0005	D DIA. ± .010	W WIDTH ± .005	T WIDTH REF.	BALL DIA. REF.	AM LGTH. ± .015	N THD. UNF. 3A	CM LGTH. +.062 -0.031	a ° MIS. ANG. REF.	ULT. STATIC RADIAL LOAD (LBS.)	APPROX. WEIGHT (LBS.)
HBBEM 8	1/2 x 1/2-20	.5000	1.500	1.250	.453	1.125	2.625	1/2-20	1.625	65	16,240	.33
HBBEM 10	5/8 x 5/8-18	.6250	1.750	1.375	.484	1.312	2.875	5/8-18	1.750	64	21,220	.51
HBBEM 12	3/4 x 3/4-16	.7500	2.000	1.500	.593	1.479	3.375	3/4-16	2.125	61	29,130	.79
HEAVY DUTY SHANK												
HBBEM 8-10	1/2 x 5/8-18	.5000	1.750	1.250	.470	1.125	.2875	5/8-18	1.750	65	24,160	.44
HBBEM 10-12	5/8 x 3/4-16	.6250	2.000	1.375	.500	1.312	3.375	3/4-16	2.125	64	30,900	.68

DO NOT INSTALL ANY COMPONENT LISTED ABOVE BEFORE READING, UNDERSTANDING AND ACCEPTING THE WARNINGS PRINTED ON PAGE 1 OF OUR CATALOG.

NOTES:

- FOR LEFT HAND THREADS ADD "L" TO PREFIX. EXAMPLE: BBEML12
- FOR STUDS ADD "Y" TO SUFFIX. EXAMPLE: BBEM12Y
- FOR TEFLON LINER ADD "T" TO SUFFIX. EXAMPLE: BBEM12T.

LUBRICATION REQUIRED

To insure proper function, the rod ends listed below must be lubricated. To insure complete lubrication, before installation, rotate ball bore 90 to installed position, fill housing with high-quality grease. Restore ball bore to installed position, wipe off excess grease and install.

CAUTION

Lubricants may attract dirt and other abrasive contamination. Rod ends must be removed, thoroughly cleaned, inspected, and re-greased whenever contamination of any kind is present. DO NOT OPERATE VEHICLE WITH WORN OR CONTAMINATED ROD ENDS

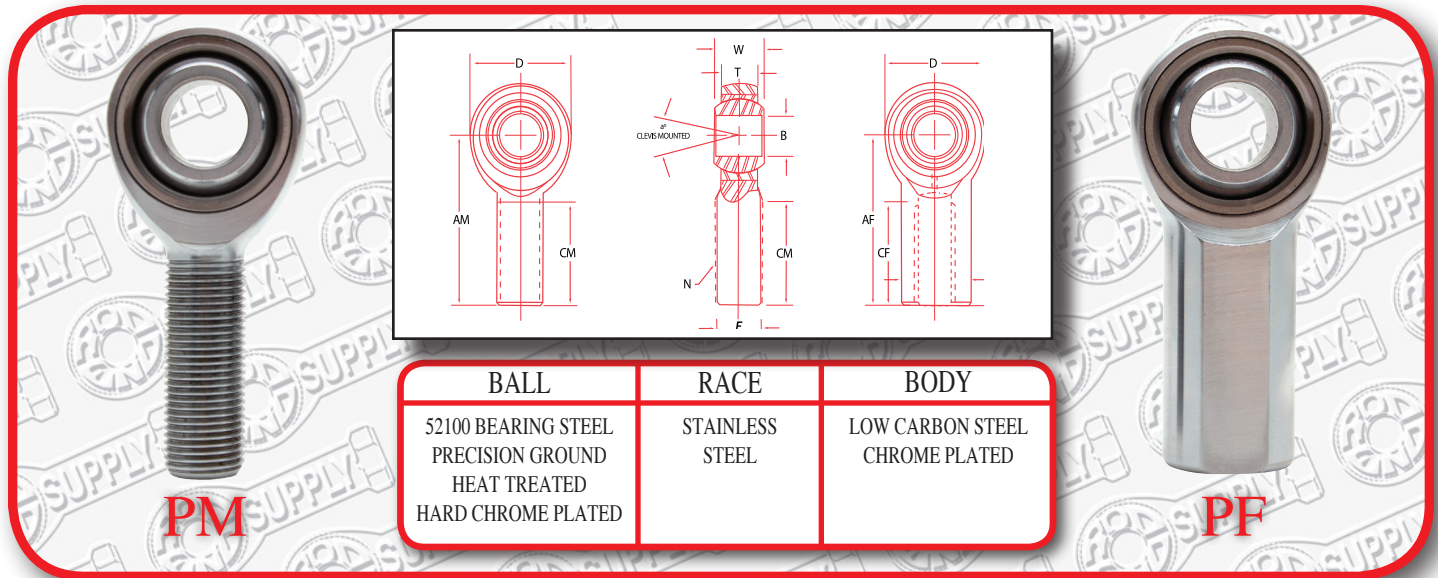

BALL	RACE	BODY
52100 BEARING STEEL PRECISION GROUND HEAT TREATED HARD CHROME PLATED	STAINLESS STEEL	LOW CARBON STEEL CHROME PLATED

RES PART NO.	BORE X THD. SIZE REF.	B DIA. +.0015 -0.005	D DIA. ± .010	W WIDTH +.000 - .005	T WIDTH ± .005	BALL DIA. REF.	AM LGTH. ± .015	AF LGTH. ± .015	N THD. UNF. 3A-2B	CM LGTH. +.062 -0.031	CF LGTH. +.062 -0.031	E DIA. ± .010	F FLAT ± .010	a° MIS. ANG. REF.	ULT. STATIC RADIAL LOAD (LBS.)	APPROX. WEIGHT (LBS.)
PM 3	3/16 x 10-32	.1900	.625	.312	.250	.437	1.250	-	10-32	.750	-	-	-	13	1,169	.03
PF 3	3/16 x 10-32	.1900	.625	.312	.250	.437	-	1.062	10-32	-	.562	.406	.312	13	1,531	.04
PM 4	1/4 x 1/4-28	.2500	.750	.375	.281	.500	1.562	-	1/4-28	1.000	-	-	-	16	2,158	.04
PF 4	1/4 x 1/4-28	.2500	.750	.375	.281	.500	-	1.132	1/4-28	-	.750	.469	.375	16	2,539	.06
PM 5	5/16 x 5/16-24	.3125	.875	.437	.344	.625	1.875	-	5/16-24	1.250	-	-	-	14	2,784	.07
PF 5	5/16 x 5/16-24	.3125	.875	.437	.344	.625	-	1.375	5/16-24	-	.750	.500	.437	14	3,133	.09
PM 6	3/8 x 3/8-24	.3750	1.000	.500	.406	.719	1.938	-	3/8-24	1.250	-	-	-	12	3,915	.11
PF 6	3/8 x 3/8-24	.3750	1.000	.500	.406	.719	-	1.625	3/8-24	-	.937	.687	.562	12	3,915	.15
PM 7	7/16 x 7/16-20	.4375	1.125	.562	.437	.812	2.125	-	7/16-20	1.375	-	-	-	14	4,218	.16
PF 7	7/16 x 7/16-20	.4375	1.125	.562	.437	.812	-	1.812	7/16-20	-	1.062	.750	.625	14	4,218	.20
PM 8	1/2 x 1/2-20	.5000	1.312	.625	.500	.937	2.438	-	1/2-20	1.500	-	-	-	12	6,660	.24
PF 8	1/2 x 1/2-20	.5000	1.312	.625	.500	.937	-	2.125	1/2-20	-	1.187	.875	.750	12	6,660	.33
PM 10	5/8 x 5/8-18	.6250	1.500	.750	.562	1.125	2.625	-	5/8-18	1.625	-	-	-	16	7,364	.37
PF 10	5/8 x 5/8-18	.6250	1.500	.750	.562	1.125	-	2.500	5/8-18	-	1.500	1.000	.875	16	7,364	.48
PM 12	3/4 x 3/4-16	.7500	1.750	.875	.687	1.312	2.875	-	3/4-16	1.750	-	-	-	14	11,518	.60
PF 12	3/4 x 3/4-16	.7500	1.750	.875	.687	1.312	-	2.875	3/4-16	-	1.750	1.125	1.000	14	11,518	.72
PM 14	7/8 x 7/8-14	.8750	2.000	.875	.765	1.375	3.375	-	7/8-14	2.000	-	-	-	17	18,476	.92
PF 14	7/8 x 7/8-14	.8750	2.000	.875	.765	1.375	-	3.375	7/8-14	-	1.875	1.300	1.125	17	18,476	1.03
PM 16-1	1 x 1-14	1.000	2.750	1.375	1.000	1.875	4.125	-	1-14	2.125	-	-	-	17	43,541	2.13
PF 16-1	1 x 1-14	1.000	2.750	1.375	1.000	1.875	-	4.125	1-14	-	2.125	1.625	1.500	17	43,541	2.41

HEAVY DUTY SHANK

PM 3-4	3/16 x 1/4-28	.1900	.750	.312	.250	.437	1.562	-	1/4-28	1.000	-	-	-	10	2,158	.04
PM 4-5	1/4 x 5/16-24	.2500	.875	.375	.281	.500	1.875	-	5/16-24	1.250	-	-	-	13	3,467	.07
PM 5-6	5/16 x 3/8-24	.3125	1.000	.437	.344	.625	1.938	-	3/8-24	1.250	-	-	-	12	5,323	.11
PM 6-7	3/8 x 7/16-20	.3750	1.125	.500	.406	.719	2.125	-	7/16-20	1.375	-	-	-	10	7,180	.16
PM 7-8	7/16 x 1/2-20	.4375	1.312	.562	.437	.812	2.438	-	1/2-20	1.500	-	-	-	12	9,620	.25
PM 8-10	1/2 x 5/8-18	.5000	1.500	.625	.500	.937	2.625	-	5/8-18	1.625	-	-	-	10	12,807	.37
PM 10-12	5/8 x 3/4-16	.6250	1.750	.750	.562	1.125	2.785	-	3/4-16	1.750	-	-	-	13	16,565	.57
PM 12-14	3/4 x 7/8-14	.7500	2.000	.875	.687	1.312	3.375	-	7/8-14	2.000	-	-	-	12	22,843	.92
PM 16	1 x 1 1/4-12	1.000	2.750	1.375	1.000	1.875	4.125	-	1 1/4-12	2.125	-	-	-	17	43,541	2.13

NOTES: DO NOT INSTALL ANY COMPONENT LISTED ABOVE BEFORE READING, UNDERSTANDING AND ACCEPTING THE WARNINGS PRINTED ON PAGE 1 OF OUR CATALOG.

- FOR LEFT HAND THREADS ADD "L" TO PREFIX. EXAMPLE: PML4
- FOR STUDS ADD "Y" TO SUFFIX. EXAMPLE: PM6Y
- FOR TEFLON LINER ADD "T" TO SUFFIX. EXAMPLE: PM12T

PMX, PFX

PRECISION - CHROMOLY STEEL





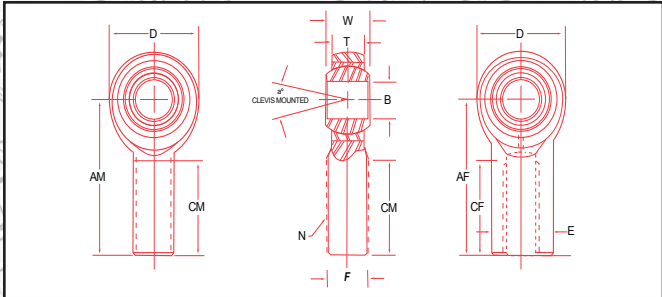



BALL	RACE	BODY
52100 BEARING STEEL PRECISION GROUND HEAT TREATED HARD CHROME PLATED	STAINLESS STEEL	4130 CHROMOLY HEAT TREATED CHROME PLATED

PMX
PFX

RES PART NO.	BORE X THD. SIZE REF.	B DIA. +.0015 -0.005	D DIA. ± .010	W WIDTH +.000 - .005	T WIDTH ± .005	BALL DIA. REF.	AM LGTH. ± .015	AF LGTH. ± .015	N THD. UNF. 3A-2B	CM LGTH. +.062 -0.031	CF LGTH. +.062 -0.031	E DIA. ± .010	F FLAT ± .010	a° MIS. ANG. REF.	ULT. STATIC RADIAL LOAD (LBS.)	APPROX. WEIGHT (LBS.)
PMX 3	3/16 x 10-32	.1900	.625	.312	.250	.437	1.250	-	10-32	.750	-	-	-	13	2,851	.03
PFX 3	3/16 x 10-32	.1900	.625	.312	.250	.437	-	1.062	10-32	-	.562	.406	.312	13	3,733	.04
PMX 4	1/4 x 1/4-28	.2500	.750	.375	.281	.500	1.562	-	1/4-28	1.000	-	-	-	16	5,260	.04
PFX 4	1/4 x 1/4-28	.2500	.750	.375	.281	.500	-	1.312	1/4-28	-	.750	.469	.375	16	6,190	.06
PMX 5	5/16 x 5/16-24	.3125	.875	.437	.344	.625	1.875	-	5/16-24	1.250	-	-	-	14	7,639	.07
PFX 5	5/16 x 5/16-24	.3125	.875	.437	.344	.625	-	1.375	5/16-24	-	.750	.500	.437	14	7,639	.09
PMX 6	3/8 x 3/8-24	.3750	1.000	.500	.406	.719	1.938	-	3/8-24	1.250	-	-	-	12	9,544	.11
PFX 6	3/8 x 3/8-24	.3750	1.000	.500	.406	.719	-	1.625	3/8-24	-	.937	.687	.562	12	9,544	.15
PMX 7	7/16 x 7/16-20	.4375	1.125	.562	.437	.812	2.125	-	7/16-20	1.375	-	-	-	14	10,285	.16
PFX 7	7/16 x 7/16-20	.4375	1.125	.562	.437	.812	-	1.812	7/16-20	-	1.062	.750	.625	14	10,285	.20
PMX 8	1/2 x 1/2-20	.5000	1.312	.625	.500	.937	2.438	-	1/2-20	1.500	-	-	-	12	16,238	.24
PFX 8	1/2 x 1/2-20	.5000	1.312	.625	.500	.937	-	2.125	1/2-20	-	1.187	.875	.750	12	16,238	.33
PMX 10	5/8 x 5/8-18	.6250	1.500	.750	.562	1.125	2.625	-	5/8-18	1.625	-	-	-	16	17,995	.37
PFX 10	5/8 x 5/8-18	.6250	1.500	.750	.562	1.125	-	2.500	5/8-18	-	1.500	1.000	.875	16	17,995	.48
PMX 12	3/4 x 3/4-16	.7500	1.750	.875	.687	1.312	2.875	-	3/4-16	1.750	-	-	-	14	28,081	.60
PFX 12	3/4 x 3/4-16	.7500	1.750	.875	.687	1.312	-	2.875	3/4-16	-	1.750	1.125	1.000	14	28,081	.72
PMX 14	7/8 x 7/8-14	.8750	2.000	.875	.765	1.375	3.375	-	7/8-14	2.000	-	-	-	17	45,051	.92
PFX 14	7/8 x 7/8-14	.8750	2.000	.875	.765	1.375	-	3.375	7/8-14	-	1.875	1.300	1.125	17	45,051	1.03
PMX 16-1	1 x 1-14	1.000	2.750	1.375	1.000	1.875	4.125	-	1-14	2.125	-	-	-	17	76,200	2.13
PFX 16-1	1 x 1-14	1.000	2.750	1.375	1.000	1.875	-	4.125	1-14	-	2.125	1.625	1.500	17	76,200	2.41

HEAVY DUTY SHANK

PMX 3-4	3/16 x 1/4-28	.1900	.750	.312	.250	.437	1.562	-	1/4-28	1.000	-	-	-	10	5,260	.04
PMX 4-5	1/4 x 5/16-24	.2500	.875	.375	.281	.500	1.875	-	5/16-24	1.250	-	-	-	13	8,452	.07
PMX 5-6	5/16 x 3/8-24	.3125	1.000	.437	.344	.625	1.938	-	3/8-24	1.250	-	-	-	12	12,978	.11
PMX 6-7	3/8 x 7/16-20	.3750	1.125	.500	.406	.719	2.125	-	7/16-20	1.375	-	-	-	10	17,508	.16
PMX 7-8	7/16 x 1/2-20	.4375	1.312	.562	.437	.812	2.438	-	1/2-20	1.500	-	-	-	12	23,452	.25
PMX 8-10	1/2 x 5/8-18	.5000	1.500	.625	.500	.937	2.625	-	5/8-18	1.625	-	-	-	10	31,390	.37
PMX 10-12	5/8 x 3/4-16	.6250	1.750	.750	.562	1.125	2.785	-	3/4-16	1.750	-	-	-	13	40,572	.57
PMX 12-14	3/4 x 7/8-14	.7500	2.000	.875	.687	1.312	3.375	-	7/8-14	2.000	-	-	-	12	55,692	.92
PMX 16	1 x 1 1/4-12	1.000	2.750	1.375	1.000	1.875	4.125	-	1 1/4-12	2.125	-	-	-	17	76,200	2.13

NOTES:

DO NOT INSTALL ANY COMPONENT LISTED ABOVE BEFORE READING, UNDERSTANDING AND ACCEPTING THE WARNINGS PRINTED ON PAGE 1 OF OUR CATALOG.

1. FOR LEFT HAND THREADS ADD "L" TO PREFIX. EXAMPLE: PMXL4
2. FOR STUDS ADD "Y" TO SUFFIX. EXAMPLE: PMX6Y
3. FOR TEFLON LINER ADD "T" TO SUFFIX. EXAMPLE: PMX12T

HPMX-T

PRECISION CHROMOLY STEEL HIGH MISALIGNMENT SERIES PTFE LINED - HEAVY DUTY



DO NOT LUBRICATE The rod ends listed below are self-lubricating. Additional lubricants may attract dirt and/or interfere with the self-lubricating properties of the component and may cause accelerated wear.
DO NOT OPERATE VEHICLE WITH WORN OR CONTAMINATED ROD ENDS

BALL	RACE	BODY
52100 BEARING STEEL PRECISION GROUND HEAT TREATED HARD CHROME PLATED	STAINLESS STEEL	4130 CHROMOLY HEAT TREATED CHROME PLATED PTFE LINED

RES PART NO.	BORE X THD. SIZE REF.	B DIA. +.0000 -0.0005	D DIA. ± .010	W WIDTH +.000 - .005	T WIDTH ± .005	BALL DIA. REF.	AM LGTH. ± .015	N THD. UNF. 3A	CM LGTH. ± .031	O DIA. REF.	a ° MIS. ANG. REF.	ULT. STATIC RADIAL LOAD (LBS.)	APPROX. WEIGHT (LBS.)
HPMX6T	3/8 x 3/8-24	.3750	1.125	.813	.355	.781	2.125	3/8-24	1.281	.512	22	11,410	.12
HPMX7T	7/16 x 7/16-20	.4375	1.312	.875	.355	.875	2.438	7/16-20	1.468	.618	21	15,760	.23
HPMX8T	1/2 x 1/2-20	.5000	1.500	.937	.411	1.000	2.625	1/2-20	1.562	.730	19	23,705	.33
HPMX10T	5/8 x 5/8-18	.6250	1.750	1.200	.577	1.250	2.875	5/8-18	1.687	.856	19	28,110	.57
HPMX12T	3/4 x 3/4-16	.7500	1.500	1.280	.630	1.375	3.375	3/4-16	2.000	.970	19	38,707	.82
HEAVY DUTY SHANK													
HPMX6-7T	3/8 x 7/16-20	.3750	1.125	.813	.355	.781	2.125	7/16-20	1.281	.512	22	16,985	.16
HPMX7-8T	7/16 x 1/2-20	.4375	1.312	.875	.355	.875	2.438	1/2-20	1.468	.618	21	19,025	.25
HPMX8-10T	1/2 x 5/8-18	.5000	1.500	.937	.411	1.000	2.625	5/8-18	1.562	.730	20	25,277	.39
HPMX10-12T	5/8 x 3/4-16	.6250	1.750	1.200	.577	1.250	2.875	3/4-16	1.687	.856	20	44,650	.60

DO NOT INSTALL ANY COMPONENT LISTED ABOVE BEFORE READING, UNDERSTANDING AND ACCEPTING THE WARNINGS PRINTED ON PAGE 1 OF OUR CATALOG.

LXM, LXF

C1045 MILD STEEL SELF LUBRICATING & SELF SEALING NYLAFIBER MATRIX RACE



DO NOT LUBRICATE The rod ends listed below are self-lubricating. Additional lubricants may attract dirt and/or interfere with the self-lubricating properties of the component and may cause accelerated wear.
DO NOT OPERATE VEHICLE WITH WORN OR CONTAMINATED ROD ENDS



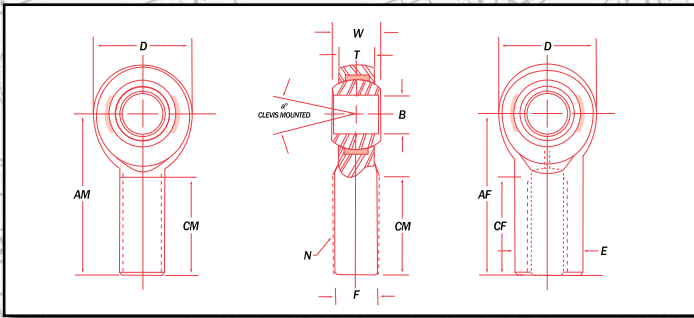



BALL	RACE	BODY
52100 BEARING STEEL PRECISION GROUND HEAT TREATED HARD CHROME PLATED	INJECTION MOLDED NYLAFIBER MATRIX	C1045 STEEL CHROME PLATED

LXM
LXF

RES PART NO.	BORE X THD. SIZE REF.	B DIA. +.0015 - .0005	D DIA. ± .010	W WIDTH + .000 - .005	T WIDTH ± .005	BALL DIA. REF.	AM LGTH. ± .015	AF LGTH. ± .015	N THD. UNF. 3A-2B	CM LGTH. +.062 - .031	CF LGTH. +.062 - .031	E DIA. ± .010	F WRENCH FLAT ± .010	a° MIS. ANG. REF.	ULT. STATIC RADIAL LOAD (LBS.)	APPROX. WEIGHT (LBS.)
LXM 3	3/16 x 10-32	.1900	.625	.312	.250	.437	1.250	-	10-32	.750	-	-	-	13	1,169	.03
LXF 3	3/16 x 10-32	.1900	.625	.312	.250	.437	-	1.062	10-32	-	.562	.406	.312	13	1,531	.04
LXM 4	1/4 x 1/4-28	.2500	.750	.375	.281	.500	1.562	-	1/4-28	1.000	-	-	-	16	2,158	.04
LXF 4	1/4 x 1/4-28	.2500	.750	.375	.281	.500	-	1.312	1/4-28	-	.750	.469	.375	16	2,539	.06
LXM 5	5/16 x 5/16-24	.3125	.875	.437	.344	.625	1.875	-	5/16-24	1.250	-	-	-	14	2,784	.07
LXF 5	5/16 x 5/16-24	.3125	.875	.437	.344	.625	-	1.375	5/16-24	-	.750	.500	.437	14	3,133	.09
LXM 6	3/8 x 3/8-24	.3750	1.000	.500	.406	.719	1.938	-	3/8-24	1.250	-	-	-	12	3,915	.11
LXF 6	3/8 x 3/8-24	.3750	1.000	.500	.406	.719	-	1.625	3/8-24	-	.937	.687	.562	12	3,915	.15
LXM 7	7/16 x 7/16-20	.4375	1.125	.562	.437	.812	2.125	-	7/16-20	1.375	-	-	-	14	4,218	.16
LXF 7	7/16 x 7/16-20	.4375	1.125	.562	.437	.812	-	1.812	7/16-20	-	1.062	.750	.625	14	4,218	.20
LXM 8	1/2 x 1/2-20	.5000	1.312	.625	.500	.937	2.438	-	1/2-20	1.500	-	-	-	12	6,660	.25
LXF 8	1/2 x 1/2-20	.5000	1.312	.625	.500	.937	-	2.125	1/2-20	-	1.187	.875	.750	12	6,660	.33
LXM 10	5/8 x 5/8-18	.6250	1.500	.750	.562	1.125	2.625	-	5/8-18	1.625	-	-	-	16	7,364	.38
LXF 10	5/8 x 5/8-18	.6250	1.500	.750	.562	1.125	-	2.500	5/8-18	-	1.500	1.000	.875	16	7,364	.48
LXM 12	3/4 x 3/4-16	.7500	1.750	.875	.687	1.312	2.875	-	3/4-16	1.750	-	-	-	14	11,518	.60
LXF 12	3/4 x 3/4-16	.7500	1.750	.875	.687	1.312	-	2.875	3/4-16	-	1.750	1.125	1.000	14	11,518	.72
LXM 14	7/8 x 7/8-14	.8750	2.000	.875	.765	1.375	3.375	-	7/8-14	2.000	-	-	-	17	18,476	.91
LXF 14	7/8 x 7/8-14	.8750	2.000	.875	.765	1.375	-	3.375	7/8-14	-	1.875	1.300	1.125	17	18,476	.93
LXM 16-1	1 x 1-14	1.000	2.750	1.375	1.015	1.875	4.125	-	1-14	2.125	-	-	-	17	43,541	2.10
LXF 16-1	1 x 1-14	1.000	2.750	1.375	1.015	1.875	-	4.125	1-14	-	2.125	1.625	1.500	17	43,541	2.50

HEAVY DUTY SHANK (NO FEMALE AVAILABLE IN HEAVY DUTY SHANK)

LXM 5-6	5/16 x 3/8-24	.3125	1.000	.437	.344	.625	1.938	-	3/8-24	1.250	-	-	-	12	5,323	.11
LXM 6-7	3/8 x 7/16-20	.3750	1.125	.500	.406	.719	2.125	-	7/16-20	1.375	-	-	-	10	7,180	.16
LXM 7-8	7/16 x 1/2-20	.4375	1.312	.562	.437	.812	2.438	-	1/2-20	1.500	-	-	-	12	9,620	.25
LXM 8-10	1/2 x 5/8-18	.5000	1.500	.625	.500	.937	2.625	-	5/8-18	1.625	-	-	-	10	12,807	.38
LXM 8-12	1/2 x 3/4-16	.5000	1.750	.750	.562	1.125	2.875	-	3/4-16	1.750	-	-	-	13	16,562	.60
LXM 10-12	5/8 x 3/4-16	.6250	1.750	.750	.562	1.125	2.875	-	3/4-16	1.750	-	-	-	13	16,565	.60
LXM 12-14	3/4 x 7/8-14	.7500	2.000	.875	.687	1.312	3.375	-	7/8-14	2.000	-	-	-	12	22,843	.92
LXM 16	1 x 1 1/4-12	1.000	2.750	1.375	1.015	1.875	4.125	-	1 1/4-12	2.125	-	-	-	17	43,541	2.41

NOTES:

- FOR LEFT HAND THREADS ADD "L" TO PREFIX. EXAMPLE: LXML12
- FOR STUDS ADD "Y" TO SUFFIX. EXAMPLE: LMX12Y

DO NOT INSTALL ANY COMPONENT LISTED ABOVE BEFORE READING, UNDERSTANDING AND ACCEPTING THE WARNINGS PRINTED ON PAGE 1 OF OUR CATALOG.

XM, XF

CHROMOLY STEEL

SELF LUBRICATING & SELF SEALING

NYLAFIBER MATRIX RACE

DO NOT LUBRICATE The rod ends listed below are self-lubricating. Additional lubricants may attract dirt and/or interfere with the self-lubricating properties of the component and may cause accelerated wear.

DO NOT OPERATE VEHICLE WITH WORN OR CONTAMINATED ROD ENDS



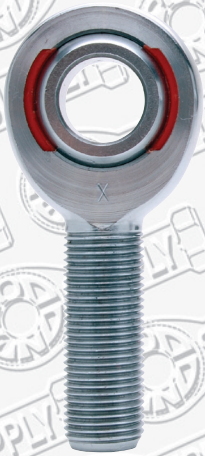

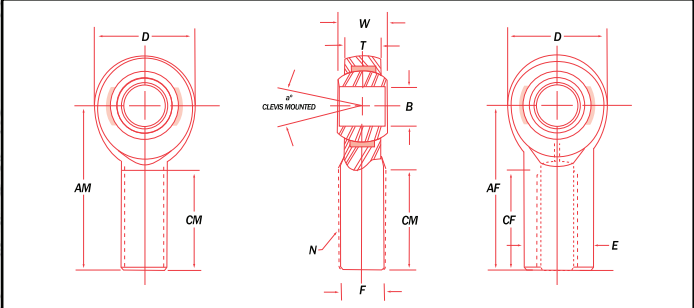



BALL	RACE	BODY
52100 BEARING STEEL PRECISION GROUND HEAT TREATED HARD CHROME PLATED	INJECTION MOLDED NYLAFIBER MATRIX	4130 CHROMOLY STEEL HEAT TREATED CHROME PLATED

XM
XF

RES PART NO.	BORE X THD. SIZE REF.	B DIA. +.0015 -0.005	D DIA. ± .010	W WIDTH + .000 - .005	T WIDTH ± .005	BALL DIA. REF.	AM LGTH. ± .015	AF LGTH. ± .015	N THD. UNF. 3A-2B	CM LGTH. +.062 -0.031	CF LGTH. +.062 -0.031	E DIA. ± .010	F WRENCH FLAT ± .010	a° MIS. ANG. REF.	ULT. STATIC RADIAL LOAD (LBS.)	APPROX. WEIGHT (LBS.)
XM 3	3/16 x 10-32	.1900	.625	.312	.250	.437	1.250	-	10-32	.750	-	-	-	13	2,851	.03
XF 3	3/16 x 10-32	.1900	.625	.312	.250	.437	-	1.062	10-32	-	.562	.406	.312	13	3,733	.04
XM 4	1/4 x 1/4-28	.2500	.750	.375	.281	.500	1.562	-	1/4-28	1.000	-	-	-	16	5,260	.04
XF 4	1/4 x 1/4-28	.2500	.750	.375	.281	.500	-	1.312	1/4-28	-	.750	.469	.375	16	6,190	.06
XM 5	5/16 x 5/16-24	.3125	.875	.437	.344	.625	1.875	-	5/16-24	1.250	-	-	-	14	7,639	.07
XF 5	5/16 x 5/16-24	.3125	.875	.437	.344	.625	-	1.375	5/16-24	-	.750	.500	.437	14	7,639	.09
XM 6	3/8 x 3/8-24	.3750	1.000	.500	.406	.719	1.938	-	3/8-24	1.250	-	-	-	12	9,544	.11
XF 6	3/8 x 3/8-24	.3750	1.000	.500	.406	.719	-	1.625	3/8-24	-	.937	.687	.562	12	9,544	.15
XM 7	7/16 x 7/16-20	.4375	1.125	.562	.437	.812	2.125	-	7/16-20	1.375	-	-	-	14	10,285	.16
XF 7	7/16 x 7/16-20	.4375	1.125	.562	.437	.812	-	1.812	7/16-20	-	1.062	.750	.625	14	10,285	.20
XM 8	1/2 x 1/2-20	.5000	1.312	.625	.500	.937	2.438	-	1/2-20	1.500	-	-	-	12	16,238	.25
XF 8	1/2 x 1/2-20	.5000	1.312	.625	.500	.937	-	2.125	1/2-20	-	1.187	.875	.750	12	16,238	.33
XM 10	5/8 x 5/8-18	.6250	1.500	.750	.562	1.125	2.625	-	5/8-18	1.625	-	-	-	16	17,955	.38
XF 10	5/8 x 5/8-18	.6250	1.500	.750	.562	1.125	-	2.500	5/8-18	-	1.500	1.000	.875	16	17,955	.48
XM 12	3/4 x 3/4-16	.7500	1.750	.875	.687	1.312	2.875	-	3/4-16	1.750	-	-	-	14	28,081	.60
XF 12	3/4 x 3/4-16	.7500	1.750	.875	.687	1.312	-	2.875	3/4-16	-	1.750	1.125	1.000	14	28,081	.72
XM 14	7/8 x 7/8-14	.8750	2.000	.875	.765	1.375	3.375	-	7/8-14	2.000	-	-	-	17	45,051	.91
XF 14	7/8 x 7/8-14	.8750	2.000	.875	.765	1.375	-	3.375	7/8-14	-	1.875	1.300	1.125	7	45,051	.93
XM 16-1	1 x 1-14	1.000	2.750	1.375	1.015	1.875	4.125	-	1-14	2.125	-	-	-	17	76,200	2.10
XF 16-1	1 x 1-14	1.000	2.750	1.375	1.015	1.875	-	4.125	1-14	-	2.125	1.625	1.500	17	76,200	2.50

HEAVY DUTY SHANK (NO FEMALE AVAILABLE IN HEAVY DUTY SHANK)

XM 5-6	5/16 x 3/8-24	.3125	1.000	.437	.344	.625	1.938	-	3/8-24	1.250	-	-	-	12	12,978	.11
XM 6-7	3/8 x 7/16-20	.3750	1.125	.500	.406	.719	2.125	-	7/16-20	1.375	-	-	-	10	17,508	.16
*XM 6-8	3/8 x 1/2-20	.3750	1.312	.625	.500	.937	2.438	-	1/2-20	1.500	-	-	-	12	23,452	.25
XM 7-8	7/16 x 1/2-20	.4375	1.312	.562	.437	.812	2.438	-	1/2-20	1.750	-	-	-	12	23,452	.25
*XM 6-10	3/8 x 5/8-18	.3750	1.500	.625	.500	.937	2.625	-	5/8-18	1.625	-	-	-	13	31,390	.38
XM 8-10	1/2 x 5/8-18	.5000	1.500	.625	.500	.937	2.625	-	5/8-18	1.625	-	-	-	10	31,390	.38
XM 8-12	1/2 x 3/4-16	.5000	1.750	.750	.562	1.125	2.875	-	3/4-16	1.750	-	-	-	13	40,572	.60
XM 10-12	5/8 x 3/4-16	.6250	1.750	.750	.562	1.125	2.875	-	3/4-16	1.750	-	-	-	13	40,572	.60
XM 12-14	3/4 x 7/8-14	.750	2.000	.875	.687	1.312	3.375	-	7/8-14	2.000	-	-	-	12	55,692	.92
XM 16	1 x 1 1/4-12	1.000	2.750	1.375	1.015	1.875	4.125	-	1 1/4-12	2.125	-	-	-	17	76,200	2.41

DO NOT INSTALL ANY COMPONENT LISTED ABOVE BEFORE READING, UNDERSTANDING AND ACCEPTING THE WARNINGS PRINTED ON PAGE 1 OF OUR CATALOG.

- NOTES:**
- FOR LEFT HAND THREADS ADD "L" TO PREFIX. EXAMPLE: XML12 * Right Hand Only
 - FOR STUDS ADD "Y" TO SUFFIX. EXAMPLE: XM12Y

AM, AF



ALUMINUM - SELF-LUBRICATING & SELF SEALING

NYLAFIBER MATRIX RACE

DO NOT LUBRICATE The rod ends listed below are self-lubricating. Additional lubricants may attract dirt and/or interfere with the self-lubricating properties of the component and may cause accelerated wear.

DO NOT OPERATE VEHICLE WITH WORN OR CONTAMINATED ROD ENDS

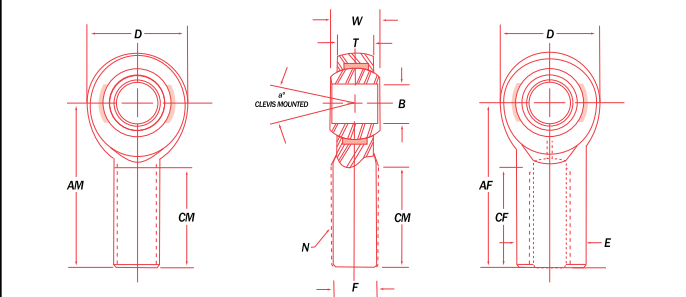

BALL	RACE	BODY
52100 BEARING STEEL PRECISION GROUND HEAT TREATED HARD CHROME PLATED	INJECTION MOLDED NYLAFIBER MATRIX	7075-T6 ALUMINUM CLEAR ANODIZED

RES PART NO.	BORE X THD. SIZE REF.	B DIA. +.0015 -0.0005	D DIA. ± .010	W WIDTH +.000 - .005	T WIDTH ± .005	BALL DIA. REF.	AM LGTH. ± .015	AF LGTH. ± .015	N THD. UNF. 3A-2B	CM LGTH. +.062 -0.031	CF LGTH. +.062 -0.031	E DIA. ± .010	F FLAT ± .010	a MIS. ANG. REF.	ULT. STATIC RADIAL LOAD (LBS.)	APPROX. WEIGHT (LBS.)
AM 3	3/16 x 10-32	.1900	.625	.312	.250	.437	1.250	-	10-32	.750	-	.406	-	13	1,350	.02
AF 3	3/16 x 10-32	.1900	.625	.312	.250	.437	-	1.062	10-32	-	.562	.406	.312	13	1,750	.03
AM 4	1/4 x 1/4-28	.2500	.750	.375	.281	.500	1.562	-	1/4-28	1.000	-	.469	-	16	2,500	.03
AF 4	1/4 x 1/4-28	.2500	.750	.375	.281	.500	-	1.312	1/4-28	-	.750	.469	.375	16	2,900	.04
AM 5	5/16 x 5/16-24	.3125	.875	.437	.344	.625	1.875	-	5/16-24	1.250	-	.500	-	14	3,200	.05
AF 5	5/16 x 5/16-24	.3125	.875	.437	.344	.625	-	1.375	5/16-24	-	.750	.500	.437	14	3,600	.06
AM 6	3/8 x 3/8-24	.3750	1.000	.500	.406	.719	1.938	-	3/8-24	1.250	-	.687	-	12	4,500	.05
AF 6	3/8 x 3/8-24	.3750	1.000	.500	.406	.719	-	1.625	3/8-24	-	.937	.687	.562	12	4,500	.07
AM 7	7/16 x 7/16-20	.4375	1.125	.562	.437	.812	2.125	-	7/16-20	1.375	-	.750	-	14	4,800	.09
AF 7	7/16 x 7/16-20	.4375	1.125	.562	.437	.812	-	1.812	7/16-20	-	1.062	.750	.625	14	10,285	.10
AM 8	1/2 x 1/2-20	.5000	1.312	.625	.500	.937	2.438	-	1/2-20	1.500	-	.875	-	12	7,700	.12
AF 8	1/2 x 1/2-20	.5000	1.312	.625	.500	.937	-	2.125	1/2-20	-	1.187	.875	.750	12	7,700	.14
AM 10	5/8 x 5/8-18	.6250	1.500	.750	.562	1.125	2.625	-	5/8-18	1.625	-	1.000	-	16	8,600	.18
AM 12	3/4 x 3/4-16	.7500	1.750	.875	.687	1.312	2.875	-	3/4-16	1.750	-	1.125	-	14	13,400	.29

HEAVY DUTY SHANK

AM 5-6	5/16 x 3/8-24	.3125	1.000	.437	.344	.625	1.938	-	3/8-24	1.250	-	-	-	12	5,800	.05
AM 6-7	3/8 x 7/16-20	.3750	1.125	.500	.406	.719	2.125	-	7/16-20	1.375	-	-	-	10	7,800	.09
*AM 6-8	3/8 x 1/2-20	.3750	1.312	.625	.500	.937	2.438	-	1/2-20	1.500	-	-	-	12	11,100	.13
*AM6-10	3/8 x 5/8-18	.3750	1.500	.625	.500	.937	2.625	-	5/8-18	1.625	-	-	-	13	15,000	.18
AM 7-8	7/16 x 1/2-20	.4375	1.312	.562	.437	.812	2.438	-	1/2-20	1.500	-	-	-	12	11,100	.13
AM 8-10	1/2 x 5/8-18	.5000	1.500	.625	.500	.937	2.625	-	5/8-18	1.625	-	-	-	10	15,000	.18
AM 10-12	5/8 x 3/4-16	.6250	1.750	.750	.562	1.125	2.875	-	3/4-16	1.750	-	-	-	13	19,300	.30

NOTES:

- FOR LEFT HAND THREADS ADD "L" TO PREFIX. EXAMPLE: AML12
- FOR STUDS ADD "Y" TO SUFFIX. EXAMPLE: AM12Y

DO NOT INSTALL ANY COMPONENT LISTED ABOVE BEFORE READING, UNDERSTANDING AND ACCEPTING THE WARNINGS PRINTED ON PAGE 1 OF OUR CATALOG

* Right Hand Only

ROD END STUDS

ENGINEERING DATA

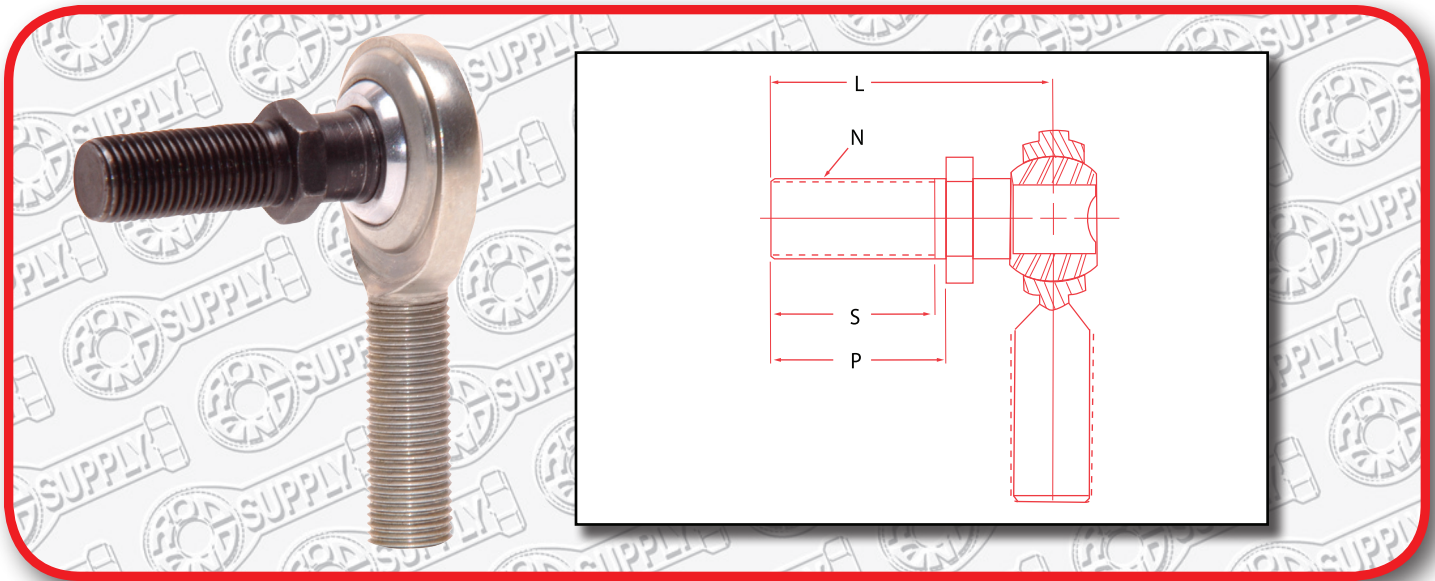

SIZE	L LENGTH +.015 -.015	P LGTH. REF.	S LGTH. MIN.	N THD. UNF 2A
3 (3/16)	1.016	.500	.437	10-32
4 (1/4)	1.031	.562	.500	1/4-28
5 (5/16)	1.219	.687	.593	5/16-24
6 (3/8)	1.562	.906	.812	3/8-24
7 (7/16)	1.750	1.062	.937	7/16-20
8 (1/2)	2.000	1.125	1.000	1/2-20
10 (5/8)	2.500	1.500	1.375	5/8-18
12 (3/4)	3.000	1.812	1.625	3/4-16

NOTES:

1. AVAILABLE ON ALL SERIES
2. STUD MATERIAL C1045 STEEL
3. STUD MISALIGNMENT APPROX. +/- 25° IN ANY DIRECTION.
4. TO SPECIFY STUD ADD "Y" TO PART NUMBER. EXAMPLE: EM6Y

STUDS AVAILABLE IN RIGHT HAND ONLY

DO NOT INSTALL ANY COMPONENT LISTED ABOVE BEFORE READING, UNDERSTANDING AND ACCEPTING THE WARNINGS PRINTED ON PAGE 1 OF OUR CATALOG.

COM/HCOM/UNIBALL CUPS

SPHERICAL BEARINGS

“Uniball”

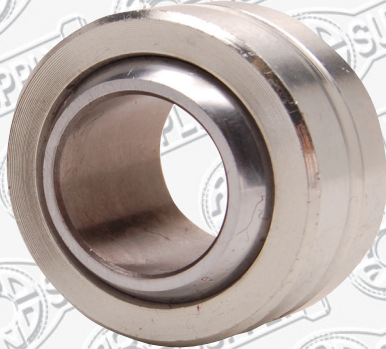

COM/HCOM

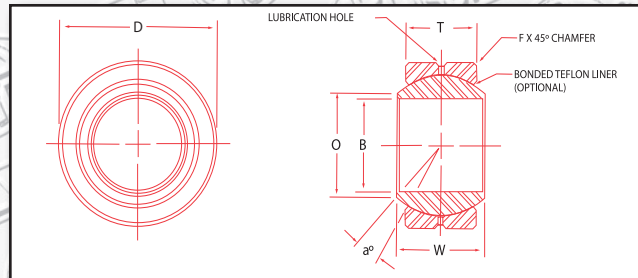

BALL	BODY
HEAT TREATED 52100 BEARING STEEL HARD CHROME PLATED	CARBON STEEL HEAT TREATED ZINC PLATED

RES PART NO.	BORE SIZE REF.	B DIA. +.0015 -0.0005	D DIA. +.000 -0.0007	W WIDTH ± .005	T WIDTH ± .005	BALL DIA. REF.	O DIA. REF.	F CHAMFER REF.	a° MIS. ANG. REF.	ULT. STATIC RADIAL LOAD (LBS.)	APPROX. WEIGHT (LBS.)
COM 3	3/16	.1900	.5625	.281	.218	.406	.293	.015	11	3,250	.014
COM 4	1/4	.2500	.6562	.343	.250	.500	.364	.022	13.5	4,950	.022
COM 5	5/16	.3125	.7500	.375	.281	.562	.419	.032	12	6,475	.030
COM 6	3/8	.3750	.8125	.406	.312	.656	.516	.032	10	8,400	.038
COM 7	7/16	.4375	.9062	.437	.343	.687	.530	.032	8	9,453	.047
COM 8	1/2	.5000	1.0000	.500	.390	.781	.600	.032	9.5	13,257	.065
COM 9	9/16	.5625	1.0937	.562	.437	.875	.671	.032	9.5	16,630	.086
COM 10	5/8	.6250	1.1875	.625	.500	.968	.739	.032	8.5	21,280	.110
COM 12	3/4	.7500	1.4375	.750	.593	1.187	.920	.044	9	31,920	.204
COM 14	7/8	.8750	1.5625	.875	.703	1.312	.980	.044	9.5	41,960	.263
COM 16	1	1.0000	1.7500	1.000	.797	1.500	1.118	.044	10	55,200	.386
HCOM 16	1	1.0000	2.0000	1.000	.781	1.687	1.360	.032	9	70,820	.553
HCOM 19	1-3/16	1.1875	2.3750	1.187	.937	2.000	1.610	.032	8.5	100,730	.895
HCOM 20	1-1/4	1.2500	2.3750	1.187	.937	2.000	1.610	.032	8.5	100,730	.895
HCOM 24	1-1/2	1.5000	2.7500	1.375	1.094	2.312	1.860	.032	8.5	135,950	1.358
HCOM 28	1-3/4	1.7500	3.1250	1.562	1.250	2.625	2.110	.044	8	176,370	1.948
HCOM 32	2	2.0000	3.5000	1.750	1.375	2.937	2.360	.044	8.5	217,060	2.650

TEFLON LINERS AVAILABLE Different body materials available

NOTES:

- LUBRICATION GROOVES IN I.D. AND O.D. OF RACE. LUBRICATION HOLES THRU RACE ONLY.
- FOR TEFLON LINER ADD "T" TO SUFFIX. EX: COM12T (UNITS WITH TEFLON LINERS HAVE NO LUBRICATION HOLES OR GROOVE IN RACE)

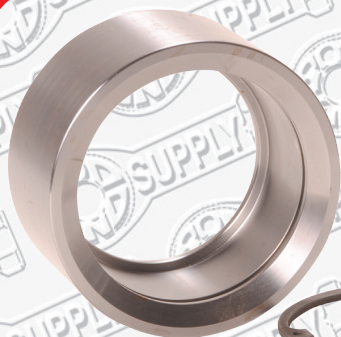

Uni Ball Cups

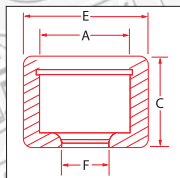

MATERIAL
ALLOY STEEL
NO PLATING

RES PART NO.	A +.0003 -0.002	C +.010 -0.010	E +.010 -0.010	F +.015 -0.015	Wall Ref.
UBC-10	1.187	0.750	1.750	0.950	.281
UBC-12	1.438	1.280	2.000	1.250	.281
UBC-14	1.563	1.500	2.200	1.690	.318
*UBC-16	2.126	1.500	2.700	1.930	.287
UBC-20	2.376	1.500	2.700	2.000	.324
UBC-24	2.751	1.500	2.700	2.375	.312

* for WSSX 16T

COM-N/HCOM-N

SPHERICAL BEARINGS

“Uniball”



DO NOT LUBRICATE The rod ends listed below are self-lubricating. Additional lubricants may attract dirt and/or interfere with the self-lubricating properties of the component and may cause accelerated wear.

DO NOT OPERATE VEHICLE WITH WORN OR CONTAMINATED ROD ENDS

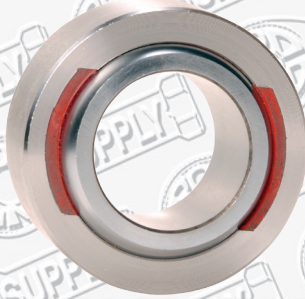

COM-N/HCOM-N

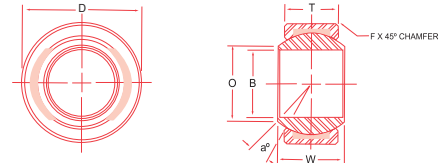

BALL	RACE	BODY
52100 BEARING STEEL HEAT TREATED HARD CHROME PLATED	INJECTION MOLDED NYLAFIBER MATRIX	CARBON STEEL HEAT TREATED ZINC PLATED

RES PART NO.	BORE SIZE REF.	B DIA. +.0015 - .0005	D DIA. + .000 - .0007	W WIDTH ± .005	T WIDTH ± .005	BALL DIA. REF.	O DIA.. REF.	F CHAMFER REF.	a° MIS. ANG. REF.	ULT. STATIC RADIAL LOAD (LBS.)	APPROX. WEIGHT (LBS.)
COM 8N	1/2	.5000	1.0000	.500	.390	.781	.600	.032	9.5	13,257	.065
COM 10N	5/8	.6250	1.1875	.625	.500	.968	.739	.032	8.5	21,280	.110
COM 12N	3/4	.7500	1.4375	.750	.593	1.187	.920	.044	9	31,920	.204
COM 14N	7/8	.8750	1.5625	.875	.703	1.312	.980	.044	9.5	41,960	.263
COM 16N	1	1.0000	1.7500	1.000	.797	1.500	1.118	.044	10	55,200	.386
HCOM 16N	1	1.0000	2.0000	1.000	.781	1.687	1.360	.032	9	70,820	.553
HCOM 20N	1-1/4	1.2500	2.3750	1.187	.937	2.000	1.610	.032	8.5	100,730	.895
HCOM 24N	1-1/2	1.5000	2.7500	1.375	1.094	2.312	1.860	.032	8.5	135,950	1.358
HCOM 32N	2	2.0000	3.5000	1.750	1.375	2.937	2.360	.044	8.5	217,060	2.650

HIN-T

SPHERICAL BEARINGS HIGH MISALIGNMENT SERIES PTFE LINED - HEAVY DUTY

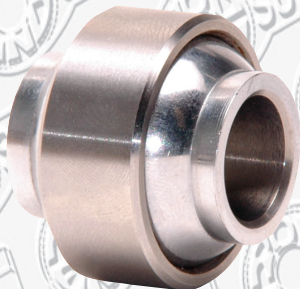

HIN-T

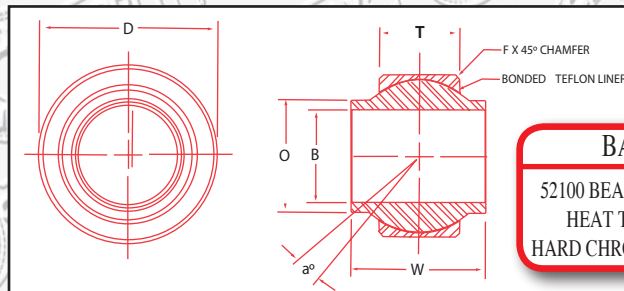

BALL	BODY
52100 BEARING STEEL HEAT TREATED HARD CHROME PLATED	STAINLESS STEEL PTFE LINED

RES PART NO.	B DIA. +.0000 - .0005	D DIA. + .0000 - .0005	W WIDTH + .000 - .005	T WIDTH + .005 - .005	BALL DIA. REF.	O DIA.. REF.	F CHAMFER REF.	a° MIS. ANG. REF.	ULT. STATIC RADIAL LOAD (LBS.)	APPROX. WEIGHT (LBS.)
HIN6T	.3750	.9060	.813	.345	.781	.512	.030	23	16,983	.068
HIN7T	.4375	1.0000	.875	.345	.875	.618	.030	22	19,023	.095
HIN8T	.5000	1.1250	.937	.401	1.000	.730	.030	20	25,275	.160
HIN10T	.6250	1.3750	1.200	.567	1.250	.856	.030	20	44,652	.245
HIN12T	.7500	1.5625	1.280	.620	1.375	.970	.035	18	53,716	.315

DO NOT INSTALL ANY COMPONENT LISTED ABOVE BEFORE READING, UNDERSTANDING AND ACCEPTING THE WARNINGS PRINTED ON PAGE 1 OF OUR CATALOG.

WSSX-T

SPHERICAL BEARINGS

WIDE SERIES, PTFE LINED

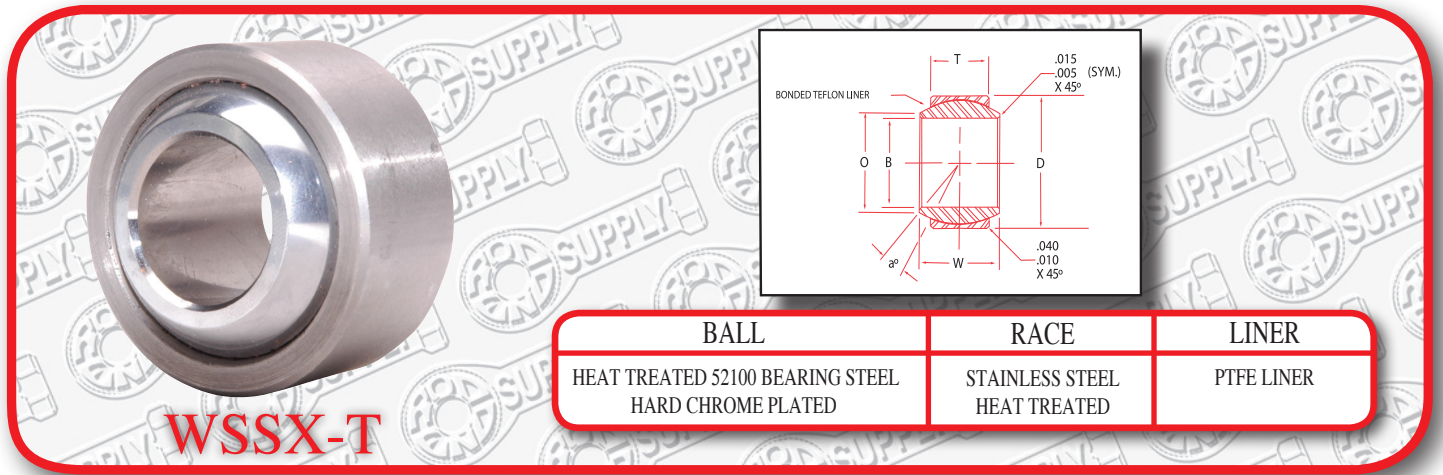

BALL	RACE	LINER
HEAT TREATED 52100 BEARING STEEL HARD CHROME PLATED	STAINLESS STEEL HEAT TREATED	PTFE LINER

BEARING PART NO.	B DIA.	D DIA.	W WIDTH	T WIDTH	O SHOULDER DIA.	BALL DIA.	a ° MIS. ANG. REF.	LOAD RATINGS (lbs.)			APPROX. WEIGHT (LBS.)
								STATIC LIMIT			
PLAIN	+ .0000 - .0005	+ .0000 - .0005	+ .000 - .002	+ .005 - .005	REF.	REF.	REF.	RADIAL (lbs.)	AXIAL (lbs.)	DYNAMIC OSCILLATING RADIAL LOAD	
WSSX3T	.1900	.6250	.437	.327	.301	.531	15	2,500	1,770	4,900	.031
WSSX4T	.2500	.6250	.437	.327	.301	.531	15	5,500	1,770	4,900	.031
WSSX5T	.3125	.6875	.437	.317	.360	.593	14	9,400	1,640	6,050	.035
WSSX6T	.3750	.8125	.500	.406	.466	.687	8	13,700	2,630	8,310	.060
WSSX7T	.4375	.9375	.562	.442	.537	.781	10	20,700	3,650	11,750	.080
WSSX8T	.5000	1.0000	.625	.505	.607	.875	9	21,400	4,970	14,950	.100
WSSX9T	.5625	1.1250	.687	.536	.721	1.000	10	26,600	5,370	18,100	.135
WSSX10T	.6250	1.1875	.750	.567	.747	1.062	12	29,000	6,130	20,250	.160
WSSX12T	.7500	1.3750	.875	.630	.845	1.250	13	37,000	7,730	26,200	.240
WSSX14T	.8750	1.6250	.875	.755	.995	1.375	6	65,200	10,800	33,600	.350
WSSX16T	1.0000	2.1250	1.375	1.005	1.269	1.875	12	104,000	19,300	56,250	.900

BORE SIZES	S LAND	R RAD.	P DEPTH
	+ .000 - .010	+ .000 - .010	+ .000 - .015
3 thru 5	.020	.015	.030
6 thru 10	.030	.020	.040
12 thru 16	.030	.020	.060

NO LOAD BREAKAWAY TORQUE

BORE SIZES	TORQUE
3	.5 to 5.0 in. lbs.
4 thru 12	1.0 to 5.0 in. lbs.
14 and 16	2.0 to 8.0 in. lbs.

NOTES:

- DIAMETER "B" AND "D" ARE CONCENTRIC WITHIN .005 T.I.R.



SWAGED ALUMINUM

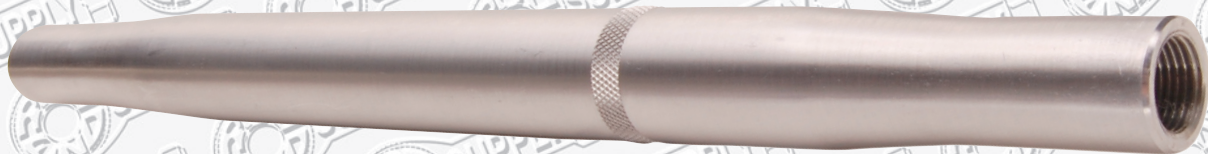

RES PART NO.	TUBING O.D.	WALL THICKNESS	THREAD SIZE	LENGTH
6815-XX	1/2	.083	5/16	4-30
6826-XX	3/4	.120	3/8	4-50
6836-XX	7/8	.156	3/8	4-50
6837-XX	7/8	.156	7/16	4-50
6838-XX	7/8	.156	1/2	4-50
6848-XX	1	.120	1/2	4-60
68410-XX	1	.120	5/8	4-60
68510-XX	1 1/8	.156	5/8	4-60
68610-XX	1 1/4	.120	5/8	5-60
68612-XX	1 1/4	.120	3/4	5-60

MATERIALS	FEATURES
6061-T6	LEFT HAND THREAD INDICATED WITH KNURLED RING

SWAGED STEEL



RES PART NO.	TUBING O.D.	WALL THICKNESS	THREAD SIZE	LENGTH
34-XX	3/4	.083	1/2	4-30
78-XX	7/8	.083	5/8	4-30
10-XX	1	.095	3/4	5-40

MATERIALS	FEATURES
DOM TUBING ASTM A-513 TYPE 5 STEEL	LEFT HAND THREAD INDICATED WITH KNURLED RING ZINC & YELLOW CHROMATE

SWAGED STAINLESS STEEL * Minimum Order Required, call for minimum.

RES PART NO.	TUBING O.D.	WALL THICKNESS	THREAD SIZE	LENGTH
SS 34-XX	3/4	.083	1/2	6-30
SS 78-XX	7/8	.083	5/8	6-30
SS 10-XX	1	.095	3/4	7-40

MATERIALS	FEATURES
304 STAINLESS STEEL	LEFT HAND THREAD INDICATED WITH KNURLED RING

RADIUS RODS

NON-SWAGED ALUMINUM



NON-SWAGED ALUMINUM

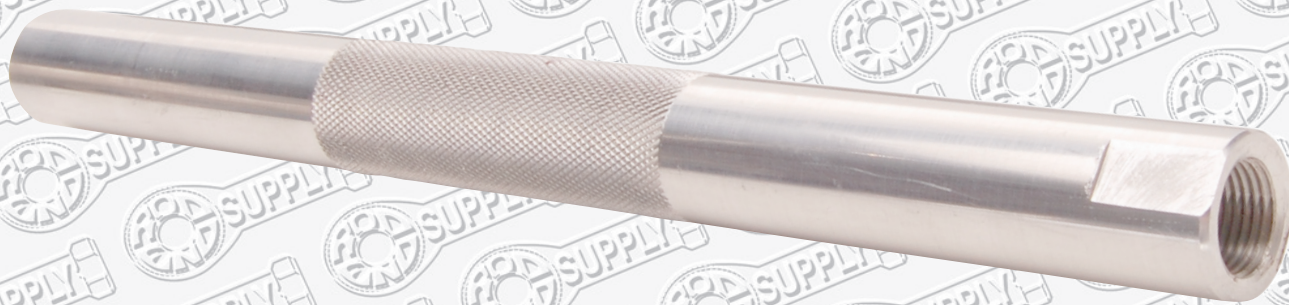

RES PART NO.	TUBING O.D.	THREAD SIZE	LENGTH
19-XX	7/8	5/8	4-40
20-XX	1	3/4	4-40

MATERIALS	FEATURES
6061-T6 .156 WALL THICKNESS Aluminum	LEFT HAND THREAD INDICATED WITH MILLED FLAT OR NOTCH

Guide to find Radius Rod Length

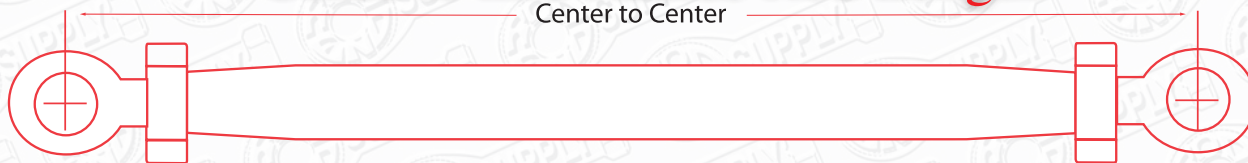

When given the center to center distance subtract the dimension below per the size of rod end to get the correct length of radius rod.

Rod End Size	Center to Center Length	Minus	=	Radius Rod Length
3/16	-	-1.75	=	
1/4	-	-1.75	=	
5/16	-	-1.75	=	
3/8	-	-2.00	=	
7/16	-	-2.00	=	
1/2	-	-2.50	=	
5/8	-	-3.00	=	
3/4	-	-3.00	=	

Example:

5/16	13.5	-1.75	=	11.75
------	------	-------	---	-------

“use 11.75 inch for your radius rod length”

NOTE: The length that you have computed using the above formula also allows for the use of jam nuts.

DO NOT INSTALL ANY COMPONENT LISTED ABOVE BEFORE READING, UNDERSTANDING AND ACCEPTING THE WARNINGS PRINTED ON PAGE 1 OF OUR CATALOG.

CLEVIS and BALL JOINTS



CLEVIS



* Left Hand Thread Available

RES PART NO.	BORE X THD. SIZE REF.	B DIA. +.005 -0.000	D DIA. +.010 -0.010	T WIDTH +.005 -0.005	A LGTH. +.015 -0.015	C LGTH. +.062 -0.031	S SLOT +.005 -0.005	N THREAD. UNF-3A	L SLOT +.005 -0.005
*CV4-5	1/4 x 5/16	.2500	.875	.625	2.250	1.250	.188	5/16-24	1.05
*CV5-5	5/16 x 5/16	.3125	.875	.625	2.250	1.250	.188	5/16-24	1.05
*CV5-6	5/16 x 3/8	.3125	.875	.625	2.250	1.250	.188	3/8-24	1.10
*CV5-8	5/16 x 1/2	.3125	1.000	.750	2.500	1.500	.250	1/2-20	1.15
*CV6-8	3/8 x 1/2	.3750	1.000	.750	2.500	1.500	.250	1/2-20	1.15
*CV6-10	3/8 x 5/8	.3750	1.125	.825	3.375	2.000	.375	5/8-18	1.50
*CV8-10	1/2 x 5/8	.5000	1.125	.825	3.375	2.000	.375	5/8-18	1.50
CV6-10SS	3/8 x 5/8	.3750	1.125	.825	3.375	2.000	.375	5/8-18	1.50
CV7-10SS	7/16 x 5/8	.4375	1.125	.825	3.375	2.000	.375	5/8-18	1.50
CV8-10CH	1/2 x 5/8	.5000	1.125	.825	3.375	2.000	.375	5/8-18	1.50

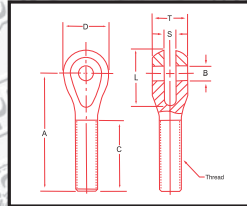

STANDARD MATERIAL
C1045 STEEL
ZINC PLATED

NOTE: SS - Stainless Steel
CH - Chrome

QUICK RELEASE

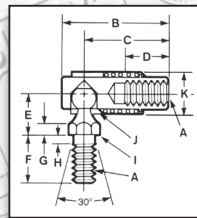
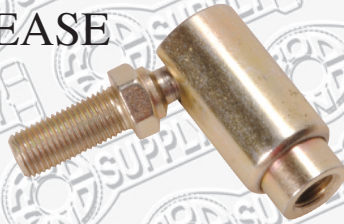

STUD	BODY
C1020 STEEL PRECISION GROUND ZINC & YELLOW DICROMATE PLATED	C1045 STEEL HEAT TREATED ZINC & YELLOW DICROMATE PLATED

RES PART NO.	A THREAD	B	C	D	E	F	G	H	I	J	K	BALL DIA.
QRBJ3	10-32	1.063	.906	.438	.438	.438	.125	.063	.313	.171	.438	.253
QRBJ4	1/4-28	1.094	.906	.500	.469	.563	.125	.063	.313	.171	.438	.253
QRBJ5	5/16-24	1.563	1.250	.563	.547	.688	.156	.094	.438	.232	.625	.341
QRBJ6	3/8-24	1.312	1.562	.750	.718	.875	.187	.093	.500	.272	.750	.414

SEALED

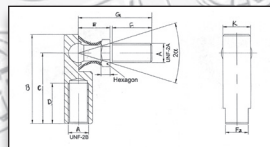

STUD	SEAL	BODY
C1020 STEEL PRECISION GROUND ZINC & YELLOW DICROMATE PLATED	BUNA N RUBBER	C1045 STEEL HEAT TREATED ZINC & YELLOW DICROMATE PLATED

RES PART NO.	A THREAD	B	C	D	E	F	G	F2 HEX	K	a ° MIS. ANG. REF.	ULT. STATIC RADIAL LOAD (LBS.)
BJF3RS	10-32	1.063	.875	.438	.438	.335	.876	.313	.375	17	850
BJF4RS	1/4-28	1.219	.969	.500	.469	.460	1.032	.375	.438	17	1,280
BJF5RS	5/16-24	1.406	1.125	.563	.531	.585	1.219	.438	.500	17	1,800
BJF6RS	3/8-24	1.688	1.375	.750	.688	.775	1.563	.500	.625	17	2,650
BJF8RS	1/2-20	2.375	1.938	1.000	.875	1.000	2.000	.625	.750	16	2,808

DO NOT INSTALL ANY COMPONENT LISTED ABOVE BEFORE READING, UNDERSTANDING AND ACCEPTING THE WARNINGS PRINTED ON PAGE 1 OF OUR CATALOG.

HIGH MISALIGNMENT SPACERS & CONE SPACERS



HIGH MISALIGNMENT SPACERS

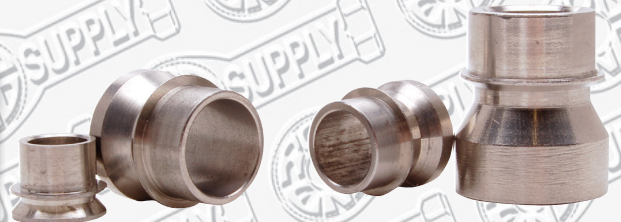
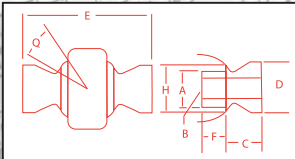

RES PART NO.	A	B	C	D	E	Q	F	H
	+0.000 -0.0015	+0.005 -0.000	+0.005 -0.005	+0.005 -0.005	+0.005 -0.005	Degrees	+0.000 -0.005	+0.002 -0.002
HMS 06-08	.500	3/8	.200	.616	1.030	29	.311	.697
HMS 08-10	.625	1/2	.462	.750	1.675	27	.373	.838
HMS 08-12	.750	1/2	.481	.890	1.835	30	.436	.970
HMS 10-12	.750	5/8	.481	.890	1.835	27	.436	.970
HMS 8-14	.875	1/2	.625	1.050	2.125	32	.436	1.055
HMS 10-14	.875	5/8	.812	1.050	2.500	23	.436	1.055
HMS 12-14	.875	3/4	.812	1.050	2.500	20	.436	1.055
HMS 10-16	1.000	5/8	.635	1.250	2.625	30	.686	1.250
HMS 12-16	1.000	3/4	.635	1.250	2.625	27	.686	1.250
HMS 12-16L	1.000	3/4	.835	1.250	3.040	27	.686	1.250
HMS 14-16	1.000	7/8	.635	1.250	2.635	24	.685	1.230
HMS 12-24	1.500	3/4	1.315	1.700	4.000	30	.680	1.817

MATERIAL
STAINLESS STEEL

Note: Q - Approximate degrees
Other sizes are available

CONE SPACERS



RES PART NO.	A	B	C	D	E	Q
CS5	.412	5/16	.083	.625	.312	22°
CS6	.500	3/8	.083	.750	.312	25°
CS7	.562	7/16	.100	.750	.375	16°
CS8	.592	1/2	.100	.875	.375	28°
CS10	.750	5/8	.100	1.000	.375	28°
CS12	.894	3/4	.125	1.375	.437	18°

CONE SPACER
MATERIAL 2024 T3 ALUMINUM

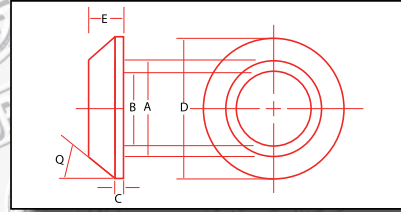

WELD-IN THREADED BUNGS



WELD-IN THREADED BUNGS ALLOY STEEL

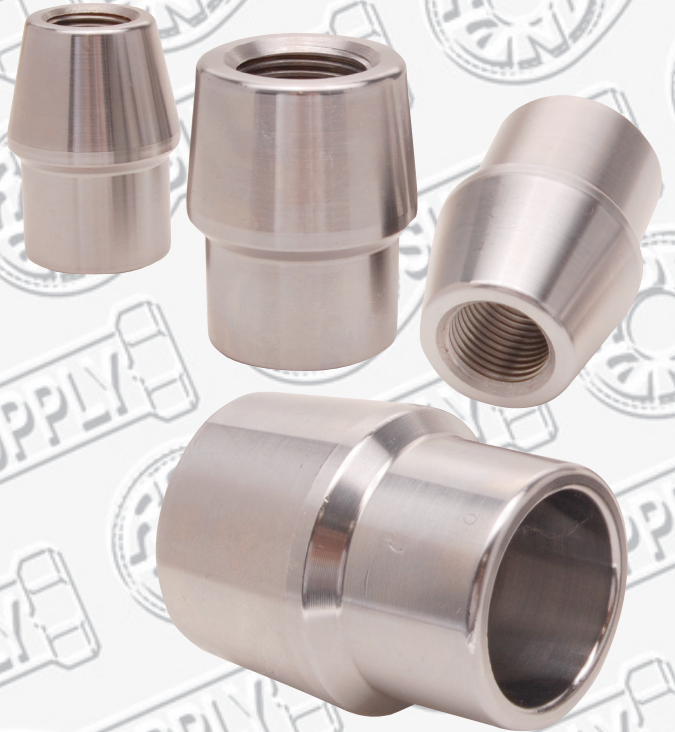

Note: Hex NOT available in right hand thread.
No plating

* Only in Hex



RES PART NO.	TUBE SIZE	TUBE ID	THREAD SIZE
C73-820 RH	5/8" OD x .058	.50	3/8-24
C73-821 LH	5/8" OD x .058	.50	3/8-24
C73-836 RH	3/4" OD x .058	.63	3/8-24
C73-837 LH	3/4" OD x .058	.63	3/8-24
C73-888 RH	1" OD x .058	.88	1/2-20
C73-889 LH	1" OD x .058	.88	1/2-20
C73-896 RH	1" OD x .065	.87	1/2-20
C73-897 LH	1" OD x .065	.87	1/2-20
C73-904 RH	1" OD x .083	.83	1/2-20
C73-905 LH	1" OD x .083	.83	1/2-20
C73-906 RH	1" OD x .083	.83	5/8-18
C73-907 LH	1" OD x .083	.83	5/8-18
C73-930 RH	1 1/8" OD x .083	.96	5/8-18
C73-931 LH	1 1/8" OD x .083	.96	5/8-18
C73-932 RH	1 1/8" OD x .083	.96	3/4-16
C73-933 LH	1 1/8" OD x .083	.96	3/4-16
C73-940 RH	1 1/4" OD x .095	1.06	5/8-18
C73-941 LH	1 1/4" OD x .095	1.06	5/8-18
C73-942 RH	1 1/4" OD x .095	1.06	3/4-16
C73-943 LH	1 1/4" OD x .095	1.06	3/4-16
C73-944 RH	1 1/4" OD x .120	1.01	5/8-18
C73-945 LH	1 1/4" OD x .120	1.01	5/8-18
C73-946 RH	1 1/4" OD x .120	1.01	3/4-16
*C73-947 LH	1 1/4" OD x .120	1.01	3/4-16
C78-104 RH	1 1/2" OD x .120	1.25	7/8-14
C78-105 LH	1 1/2" OD x .120	1.25	7/8-14
C73-16-1 RH	2" OD x .250	1.50	1-14
C73-16-1 LH	2" OD x .250	1.50	1-14
C73-16 RH	2" OD x .120	1.75	1 1/4-12
C73-16 LH	2" OD x .120	1.75	1 1/4-12
C73-16DJ RH	2" OD x .250	1.50	1 1/4-12
C73-16DJ LH	2" OD x .250	1.50	1 1/4-12



SPRINT CAR/MIDGET SUSPENSION/STEERING PARTS



PITMAN ARMS



PITMAN ARM 14" (PA-14)



PITMAN ARM 12" (PA-12)



PITMAN ARM 9" (PA-9)

TORSION ARMS

LEFT REAR (LRTA)



RIGHT REAR (RRTA)



FRONT TORSION ARM (TA-19L) OTHER TORSION ARMS AVAILABLE



JACOBS LADDER

JL-13.625

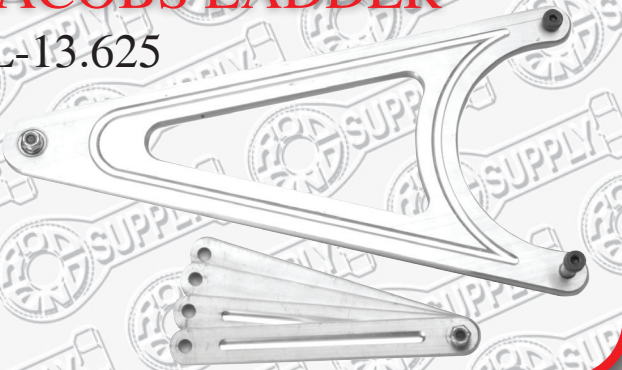

TORSION STOPS

MTS-1.75

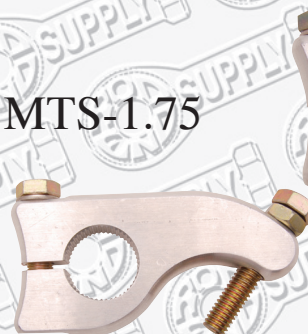

TS-200



SPRINT CAR/MIDGET SUSPENSION/STEERING PARTS



STEERING ARMS

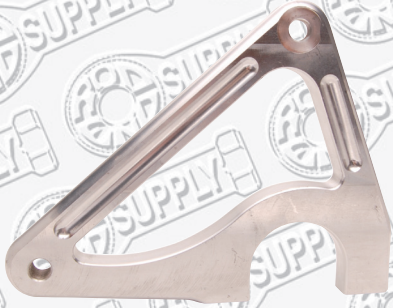

COMBO STEERING ARM
CSA-375R



SA375 STEERING ARM

SPINDLE SP325

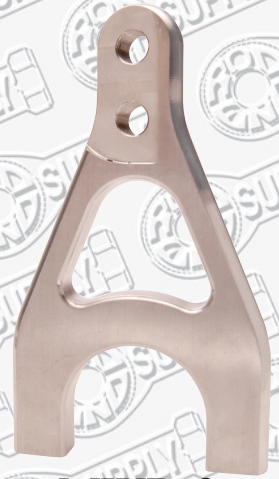

MWB-3

TORSION BARS



Multiple Versions, Call your Representative.

BELL CRANKS

BC1

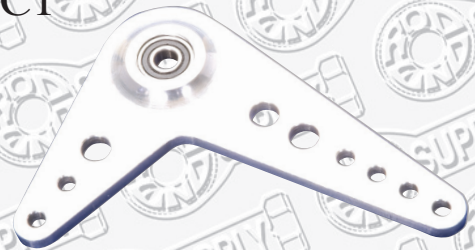

Quick Mount Shock Bolts

2024 T3 Cold Finish Aluminum
Black Anodized
Universal
8 bolts & keepers per set
Fully Tested

Individual Parts are available



SPRINT CAR/MIDGET
SUSPENSION/STEERING PARTS



**BIRD CAGES
& BEARINGS**

**ASPHALT BIRD CAGES
& BEARINGS**

BC-4000

BC-5000

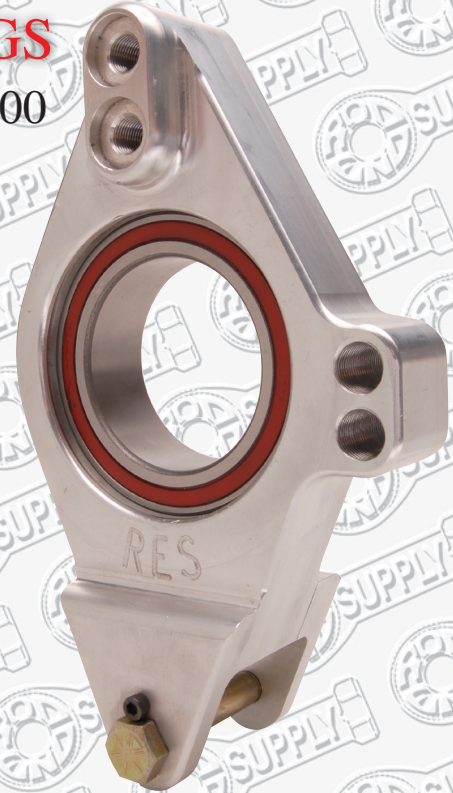
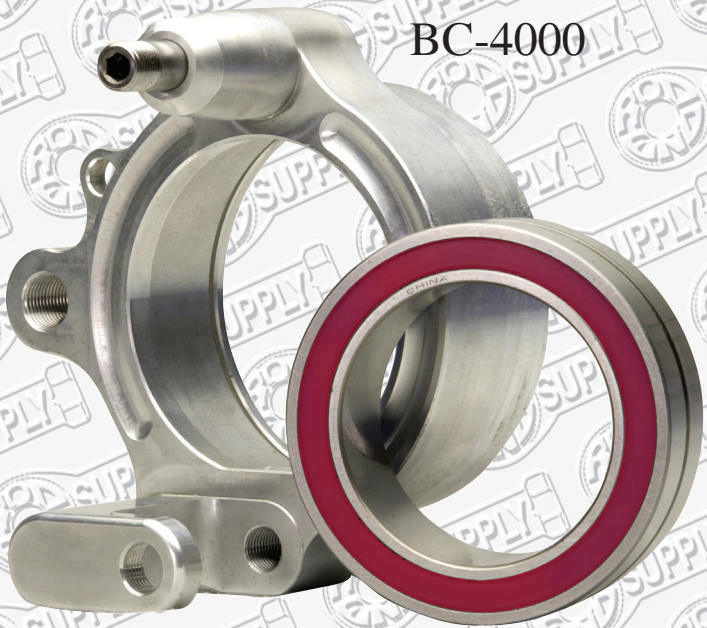

59142RSG-28
59142RSG-32

**MIDGET BIRD
CAGE**

MICRO BIRD CAGE

MBC-200

MBC-600

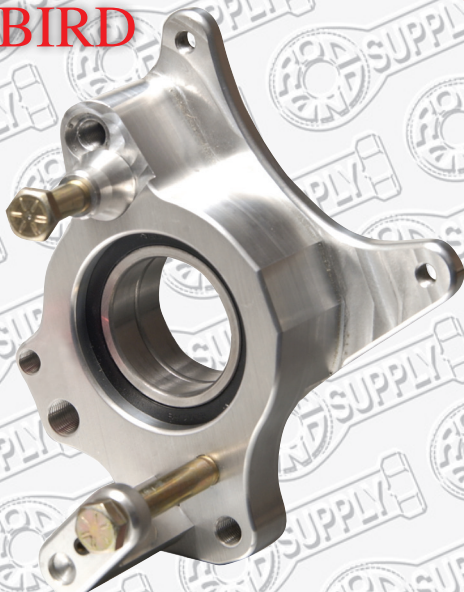

DO NOT INSTALL ANY COMPONENT LISTED ABOVE BEFORE READING, UNDERSTANDING AND ACCEPTING THE WARNINGS PRINTED ON PAGE 1 OF OUR CATALOG.

MODIFIED/ LATE MODEL PARTS



LATE MODEL BIRD CAGE ACCESSORIES

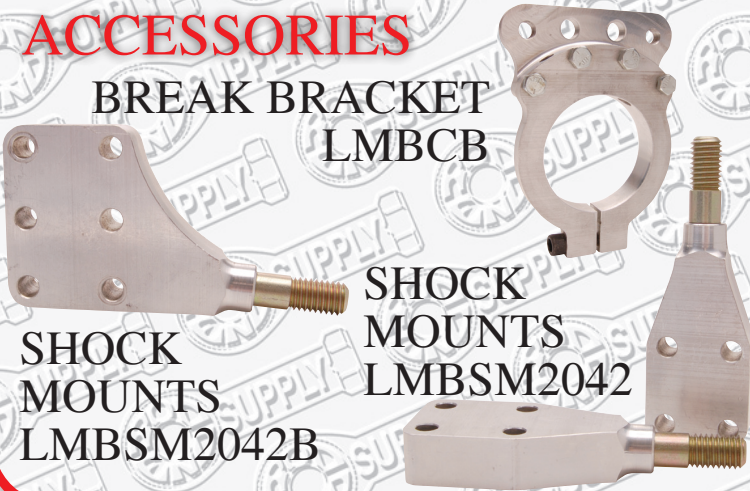

BREAK BRACKET
LMBCB

SHOCK
MOUNTS
LMBSM2042B

SHOCK
MOUNTS
LMBSM2042

LATE MODEL BIRD CAGE



LMBC-3110
SWB

LMBC-2002B

MODIFIED BALL BEARING BIRD CAGES



SHOCK MOUNT
SWIVEL

STEEL
COMBO
MCBBC4035

STEEL
SWING ARM
MSABC4045

J-BAR
CALL FOR AVAILABLE SIZES

WEIGHT MOUNT CLAMP



WMB-1.75
Mult. Sizes Avail.

WMBS2.0

SMALL BLOCK MOTOR MOUNT

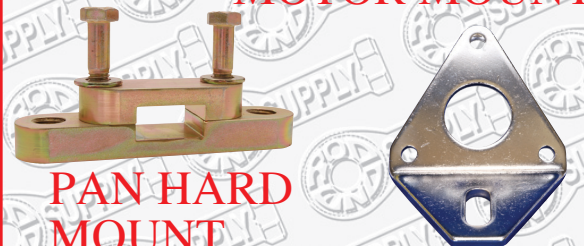

PAN HARD
MOUNT
PM1.5 & 2.0

MMSB

DO NOT INSTALL ANY COMPONENT LISTED ABOVE BEFORE READING, UNDERSTANDING AND ACCEPTING THE WARNINGS PRINTED ON PAGE 1 OF OUR CATALOG.



FOUR BAR END

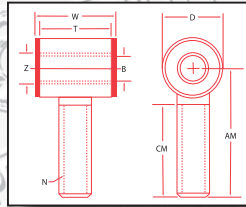

BUSHING	BODY
POLYURETHANE w/STAINLESS STEEL SLEEVE	C1045 STEEL BLACK OXIDE or CHROME also 304 STAINLESS STEEL

* AVAILABLE IN LEFT HAND THREADS

RES PART NO.	BORE X THD. SIZE REF.	B DIA. + .005 - .000	Z DIA. ± .010	D DIA. ± .010	W ± .010	T WIDTH ± .010	AM LGTH ± .015	CM LGTH + .062 - .031	N THD. UNF 3A-2B
FBE10	1/2 x 5/8-18	.500	.750	1.375	1.470	1.070	2.85	2.000	5/8-18
FBE12	5/8 x 3/4-16	.625	.750	1.640	1.685	1.300	3.00	2.000	3/4-16

ROD EYE

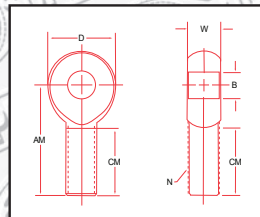
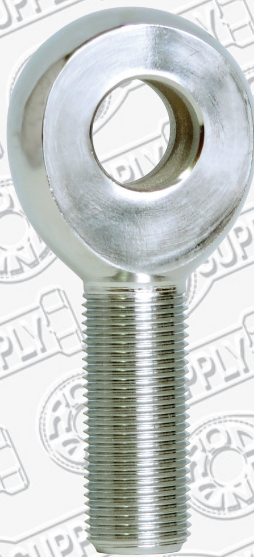

BODY
C1045 STEEL CHROME PLATED

RES PART NO.	BORE X THD. SIZE REF.	B DIA. + .005 - .000	D DIA. ± .010	W WIDTH ± .005	AM LGTH ± .015	CM LGTH + .062 - .031	N THD. UNF 3A-2B
RE 8	1/2 x 1/2-20	.500	1.312	.625	2.437	1.500	1/2-20
RE 10	5/8 x 5/8-18	.625	1.500	.750	2.625	1.625	5/8-18
RE 10-12	5/8 x 3/4-16	.625	1.750	.875	2.875	1.750	3/4-16
RE 12	3/4 x 3/4-16	.750	1.750	.875	2.875	1.750	3/4-16



Female Adjuster
4.25" Length - 5/8-18 LH x 3/4-16 RH



Male Adjuster
4.5" Length - 3/4-16 RH & LH



LOCK NUTS



RIGHT HAND	THREAD SIZE	HEX SIZE
LNRC04	1/4-20	7/16
LNRC05	5/16-18	1/2
LNRC06	3/8-16	9/16
LNRC07	7/16-14	11/16
LNRC08	1/2-13	3/4
LNRC10	5/8-11	15/16
LNRC12	3/4-10	1 1/8

RIGHT HAND	THREAD SIZE	HEX SIZE
LNR04	1/4-28	7/16
LNR05	5/16-24	1/2
LNR06	3/8-24	9/16
LNR07	7/16-20	11/16
LNR08	1/2-20	3/4
LNR10	5/8-18	15/16
LNR12	3/4-16	1 1/8

JAM NUTS



STEEL - LOW CARBON - ZINC PLATED			
RIGHT HAND	LEFT HAND	THREAD SIZE	HEX SIZE
SJNR03	SJNL03	10-32	7/16
SJNR04	SJNL04	1/4-28	7/16
SJNR05	SJNL05	5/16-24	1/2
SJNR06	SJNL06	3/8-24	9/16
SJNR07	SJNL07	7/16-20	11/16
SJNR08	SJNL08	1/2-20	3/4
SJNR10	SJNL10	5/8-18	15/16
SJNR10SM	SJNL10SM	5/8-18	3/4
SJNR12	SJNL12	3/4-16	1 1/8
SJNR14	SJNL14	7/8-14	1 1/4
SJNR16-1	SJNL16-1	1-14	1 13/16
SJNR16	SJNL16	1 1/4-12	1 5/8

ALUMINUM - 2024-T6			
RIGHT HAND	LEFT HAND	THREAD SIZE	HEX SIZE
AJNR03	AJNL03	10-32	7/16
AJNR04	AJNL04	1/4-28	7/16
AJNR05	AJNL05	5/16-24	1/2
AJNR06	AJNL06	3/8-24	9/16
AJNR07	AJNL07	7/16-20	11/16
AJNR08	AJNL08	1/2-20	3/4
AJNR10	AJNL10	5/8-18	3/4
AJNR12	AJNL12	3/4-16	1 1/8

DO NOT INSTALL ANY COMPONENT LISTED ABOVE BEFORE READING, UNDERSTANDING AND ACCEPTING THE WARNINGS PRINTED ON PAGE 1 OF OUR CATALOG.

CUSTOM PRODUCTS

We Private Label for Manufacturers

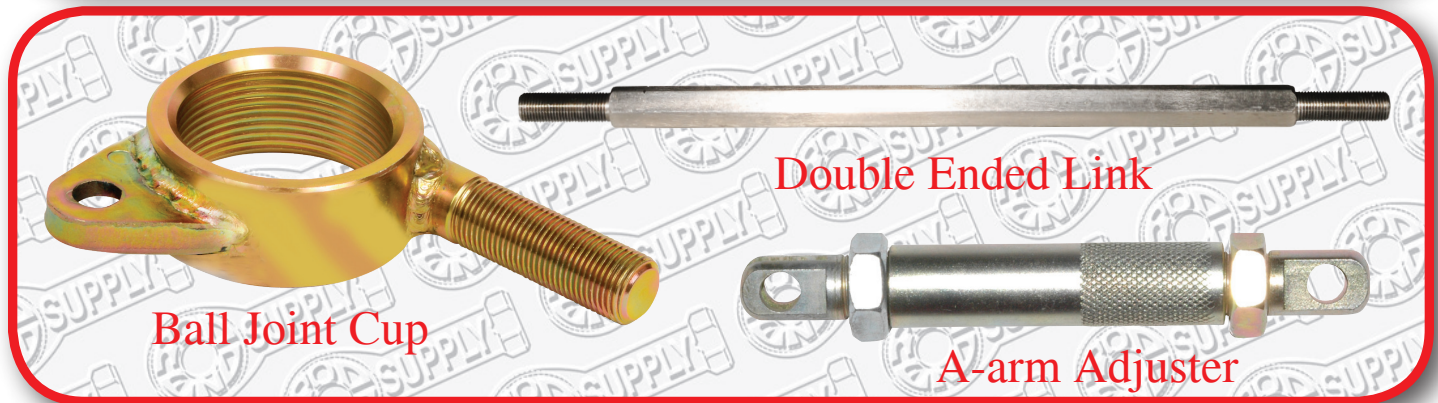

CUSTOM PRODUCTS

We Private Label for Manufacturers



LEGEND CAR CLEVIS

BEARINGS

DOUBLE END LINK

J BAR WELD-IN

BELL CRANK

CRAWLER JOINT PARTS

LEVER ARM ROD END

LINKAGE

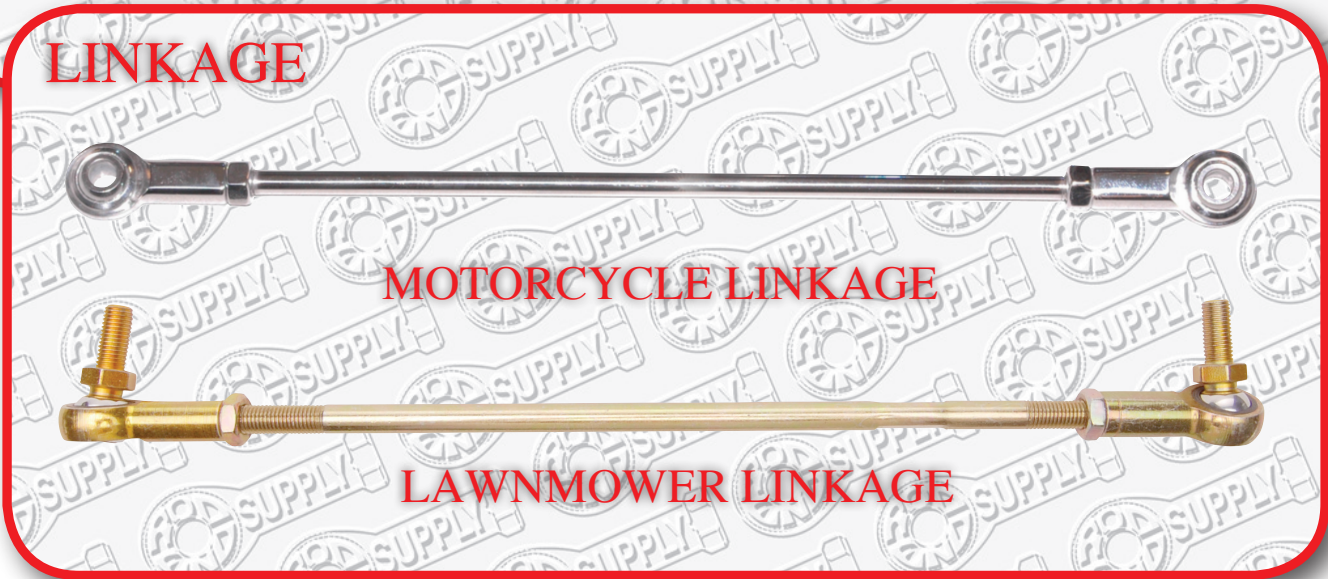

MOTORCYCLE LINKAGE

LAWNMOWER LINKAGE

www.rodendsupply.com
info@rodendsupply.com

ROD END SUPPLY, INC.
ORDER FORM

Phone: (913) 768-1017
FAX: (913) 768-4462

MAIL or FAX YOUR ROD END SUPPLY ORDER FORM

Bill To:

Ship To:

Name _____ Name _____

Address _____ Address _____

City _____ State _____ Zip/PC _____ City _____ State _____ Zip/PC _____

Province _____ Country _____ Province _____ Country _____

Phone: _____ FAX #: _____ Phone: _____ FAX #: _____

E-mail Address: _____ E-mail Address: _____

Attention: _____ Attention: _____

PRODUCT INFORMATION

Item NO.	Qty.	Description	Price	Total

Warranty Disclaimer
Rod End Supply, Inc. makes No warranties whatsoever, expressed or implied, oral or written to purchaser. There is NO warranty of merchantability made to purchaser. Ordering any parts from Rod End Supply, Inc. is the sole responsibility of the purchaser and to his discretion as to the correctness of the parts for his application. Rod End Supply, Inc. take absolutely no responsibility for the correctness of the application of the parts or for the use of the parts. If, and in the event that the purchaser expressly or impliedly cause representations, or statement, or affirmations of fact contrary to this disclaimer of all warranties, expressed or implied, then purchasers agree to indemnify and hold harmless Rod End Supply, Inc. in the event of any claim, demand, or legal action against Rod End Supply, Inc. by any purchaser.

(Check one box) VISA Discover MasterCard
 (13/16 digits) (16 digits) (16 digits)

C.O.D. Card Number
 Payment Enclosed

Check or money order, _____ EXP. DATE
payable to _____ Print Cardholder's Name
Rod End Supply, Inc. _____
Signature _____

Total	_____
Freight	_____
Subtotal	_____
Sales Tax	_____
Total Amount	_____

Mail To: Rod End Supply
1128 S Payne - 66061
P.O. Box 2080
Olathe, KS 66051

Or Call Toll Free:
1-800-284-2902 or
913-768-1017
8 a.m. - 4:30 p.m. Central

Or FAX: 913-768-4462

ALL MERCHANDISE F.O.B. ROD END SUPPLY, INC. OLATHE, KS. UNLESS SPECIFIED

INTERCHANGE TABLE

ROD END SUPPLY	ALINABAL	AURORA	F-K	HEIM/BOSTON	MORSE/SPHERCO	NATIONAL	QA 1
Male Rod Ends							
EM PM PMX AM LXM XM BBEM HPMX-T HBBEM	AM LCRM-X5 RM-X5 ARM-X5 LCRM-X5 RM-X5	CM MM AM ALM/XALM XM/XM AM/XAM HXAM-T	CM JM/RSM JMX/RSMX ALJM/ALRSM KM KMX CMX HRSMX-T	M-CR HMA BHM	CFM ARE	MSM MTSM TSMX KCA/KCAX MTST/TSMX-T TSMX/TSMX-T MAX/XMAX	CM KM HM AM EXM XM PCM PCYM
Female Rod Ends							
EF PF PFX LXF XF	AF CF	CW MW/KW AW	CF JF JFX	F-CR HFA	CFF	MSF MTSF TSFX	CF KF HF EXF XF
Spherical Bearings							
COM WSSX-T HIN-T COM-N	CBAC	COM PWB-T HAB-T	COM WSSX-T HIN-T	COM	COM	COM	COM WPB-T YPB-T SLB
Ball Joints							
QRB						SS	

NOTE: This interchange table shows approximate equivalency. It is not intended that all manufacturers' products are functionally interchangeable in all applications. All information, data and dimension tables in this catalog have been carefully compiled and thoroughly checked. However, no responsibility for possible errors or omissions can be assumed.

In an effort to offer our customers the lowest prices, quickest service and greatest value, Rod End Supply reserves the right to change suppliers, specifications, colors, materials and prices. Each of the previous items is subject to change without notice. Rod End Supply is not responsible for any typographical errors or misinterpretations. Quantities are limited on some items.

Sales Policy

Prices: All prices and policies are subject to change without notice. Contact Rod End Supply, Inc. for current prices and policies.

Shipping

All merchandise F.O.B. Rod End Supply, Inc., Olathe, KS., unless specified. All shipments will be sent by method of transportation specified by purchaser.

Damage Claims

Always inspect your package upon delivery. Inspect all packages in the presence of the delivery driver, the driver must note any damage. Ask the drivers the carriers procedures for handling damaged claims. You must hold the original box packing material and damaged merchandise for inspection or the carrier will not honor the claim. You must notify Rod End Supply Customer Service Department for instructions on returning damaged goods. Rod End Supply is not responsible if no notification is given within five days of receipt.

Shortages

Always check the contents of your delivery to ensure all the parts that you ordered were received. Please read the invoice. Double check all packing materials, small items may be wrapped inside with these products. Shortages may occur from damage, so save all packing materials. Inspect the box for holes that would allow parts to fall out. If you are missing any items be sure to check your invoice for back orders or cancelled items before calling the customer service department. If Rod End Supply has to split a shipment into multiple boxes, UPS may deliver packages on different days. If a shortage has occurred, save the box and packaging material. You need to contact the customer service department within five days of delivery to assure the prompt replacement. Rod End Supply assumes no liability after this period.

Refusals

All refused COD customers will be billed a 25% restocking charge plus freight to and from the destination.

Warranty Claims

If an item has a manufactures warranty as being free from defects we will exchange only.

Returns

Special ordered parts are non-refundable. All freight and handling must be prepaid. All returns subject to 25% restocking fee and prepaid freight.

Back Orders

Back orders will be shipped unless specified.

Ordering

Please state part number, full description of item(s) and quantity desired. Fill out your name, address and phone number. If your mailing address and street address are different, please give both with mailing directions.

Hours 8:00 a.m. - 4:30 p.m. Monday thru Friday

